

## SERIES SAA-75 RF COAXIAL CONNECTORS

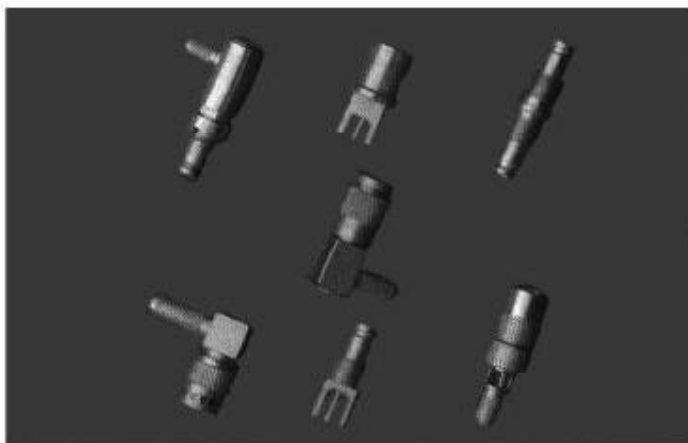

Series SAA-75 is super small style RF coaxial connector, in common use construction contain push-pull self-latching style and screw-coupling style. The advantages are connection convenience, reliable connection and vibration resistance etc.

### Key performance

Characteristic impedance:  $75 \Omega$   
 Frequency range: 0-1GHz  
 Contact resistance:  
     Center conductor :  $\leq 10.0 m\Omega$   
     Out conductor :  $\leq 3.0 m\Omega$   
 Insulation resistance :  $\geq 1000 M\Omega$   
 Insulator voltage withstanding : 750V  
 VSWR :  $\leq 1.30$   
 Connector durability : 500  
**Applicable spec/std: DIN47297**

### Material

Center contacts:  
     Male---brass, gold plated.  
     Female---beryllium copper, gold plated  
 Bodies and other metal parts:  
     brass, gold plated  
 Insulators: Teflon  
 Crimp ferrule: copper, nickel plated.  
 Gasket and seal rings: silicone rubber  
 Heat-shrink tubing: thermofit plastic.

### Interface Dimensions

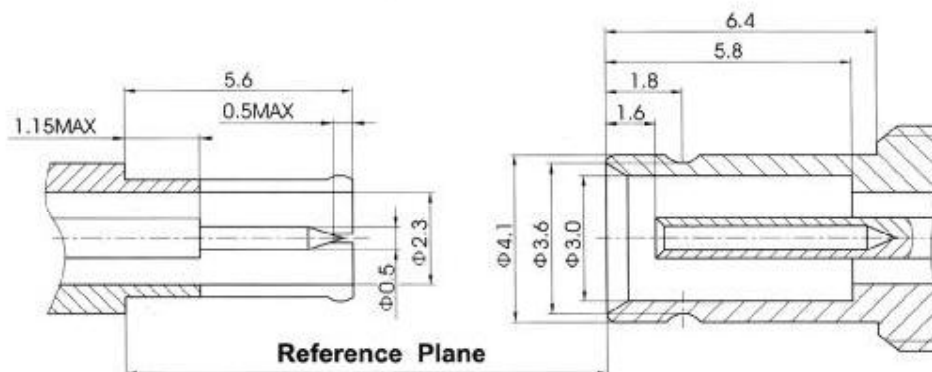

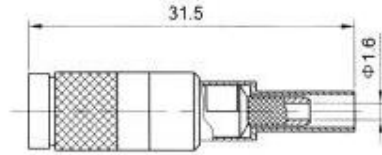

Type part number suitable cable Note

SAA-75J32 5211-6501 32

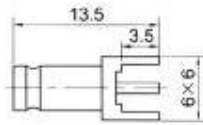

mounting hole

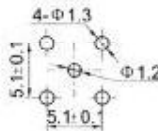

Type part number Note

SAA-75KHD 5200-5800

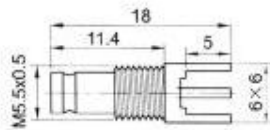

mounting hole

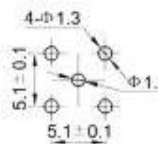

Type part number Note

SAA-75KHD1 5200-5801

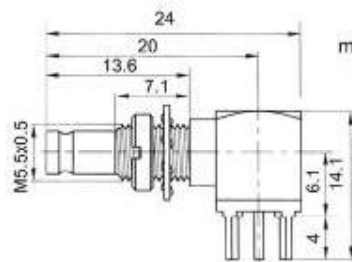

mounting hole

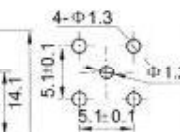

Type part number Note

SAA-75KYWHD2 5240-7801

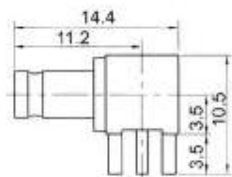

mounting hole

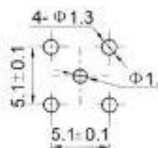

Type part number Note

SAA-75KWHD 5240-5800

Series SAA - 75 RF coaxial connector with screw

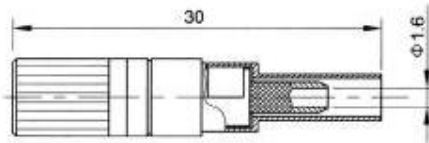

Type	part number	suitable cable	Note
------	-------------	----------------	------

SAA-L75J3	5211-6501	3	
-----------	-----------	---	--

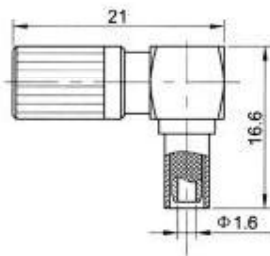

Type	part number	suitable cable	Note
------	-------------	----------------	------

SAA-L75JW3	5231-6501	3	
------------	-----------	---	--

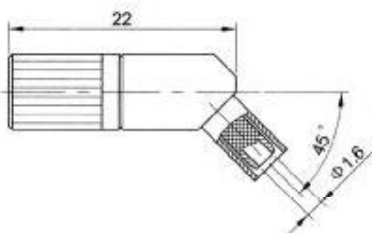

Type	part number	suitable cable	Note
------	-------------	----------------	------

SAA-L75JW3A	5231-6502	3	
-------------	-----------	---	--