

**SERIES BMA
RF COAXIAL CONNECTORS**

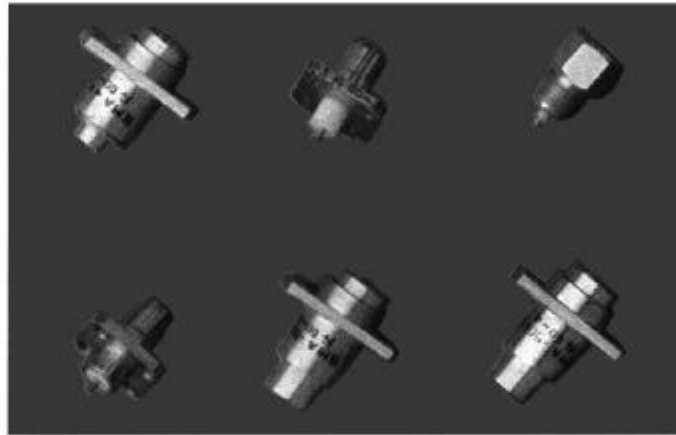

Series BMA connectors are blind mating with slide-on insertion. BMA connectors are recommended for use in multiple mounting or rack and panel applications.

Key performance

- Characteristic Impedance : 50 Ω
- Frequency range : 0~22GHz
- Contact resistance :
 - Center conductor ≤2.0m Ω
 - Out conductor ≤2.0m Ω
- Insulation resistance : ≥5000M Ω
- Insulator voltage withstanding : 1500V
- VSWR : ≤1.30
- Connector durability :1000 cycles
- Applicable spec/std : GJB681A (DIN47297)

Material

- Center contacts:
 - Male---brass, gold plated.
 - Female---beryllium copper, gold plated
- Bodies other metal parts:
 - brass, gold plated
- Insulators: Teflon
- Crimp ferrule: copper, nickel plated.
- Gasket and seal rings: silicone rubber
- Heat-shrink tubing: thermofit plastic.

Interface Dimensions

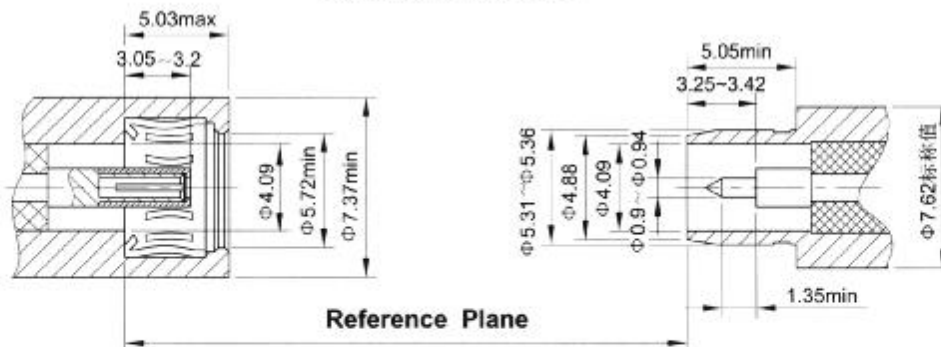

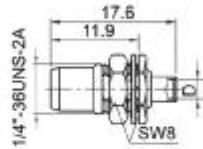

mounting hole

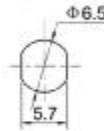

Type	part number	suitable cable	D	Note
BMA-JYB2	0110-2601	B2	Φ2.2	
BMA-JYB3	0110-2602	B3	Φ3.6	

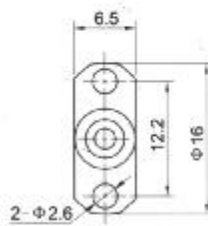
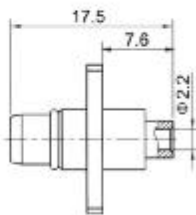

Type	part number	suitable cable	Note
BMA-JFB2	0110-1601	B2	

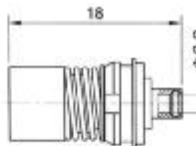

mounting hole

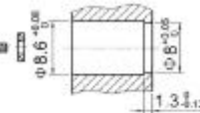

Type	part number	suitable cable	Note
BMA-KB2	0120-6601	B2	

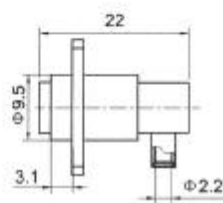

mounting hole

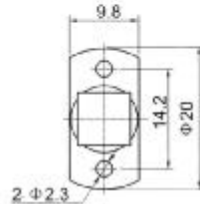

Type	part number	suitable cable	Note
BMA-KWFB2	0120-1601	B2	

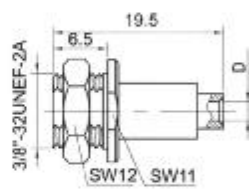

mounting hole

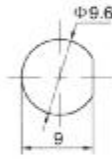

Type	part number	suitable cable	D	Note
BMA-KYB2	0120-2601	B2	Φ2.2	
BMA-KYB3	0120-2602	B3	Φ3.6	

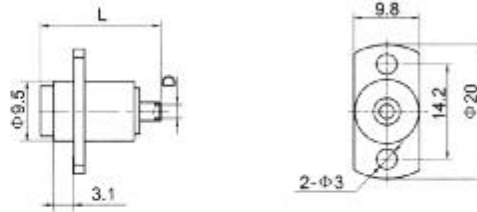

Type	part number	suitable cable	L	D	Note
BMA-KFB2	0121-1601	B2	18.2	φ2.2	
BMA-KFB3	0121-1602	B3	18.2	φ3.6	
BMA-KFB3-G	0124-1601	B3	18.2	φ3.6	stainless steel flange body
BMA-KFB5A	0121-1604	B5A	26.4	φ6.5	

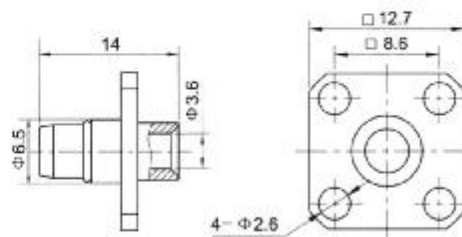

Type	part number	suitable cable	Note
BMA-JFB3	0110-1602	B3	

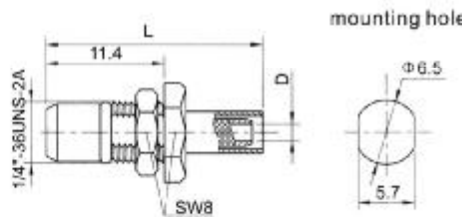

Type	part number	suitable cable	L	D	Note
BMA-JY3	0110-2501	3	20	φ1.6	
BMA-JY5	0110-2502	5	19	φ3.1	

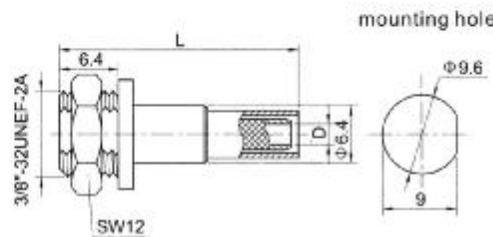

Type	part number	suitable cable	L	D	Note
BMA-KY3	0120-2501	3	22.6	φ1.6	
BMA-KY4A	0120-2503	4	26.4	φ2.3	
BMA-KY5	0120-2504	5	30.6	φ3.1	

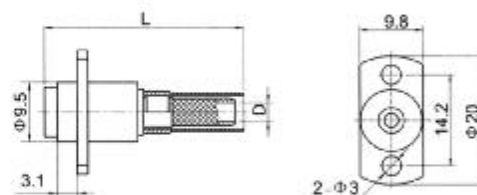

Type	part number	suitable cable	L	D	Note
BMA-KF3	0121-1501	3	29.8	φ1.6	
BMA-KF4	0121-1502	4	31.1	φ2.3	
BMA-KF5A	0121-1503	5	31.8	φ3.1	

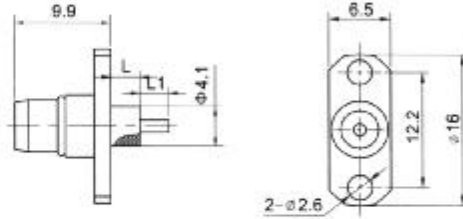

Type	part number	L	L1	Note
BMA-JFD	0110-0001	32	2	
BMA-JFD6	0110-0007	84	4	
BMA-JFD7	0110-0008	6	2	

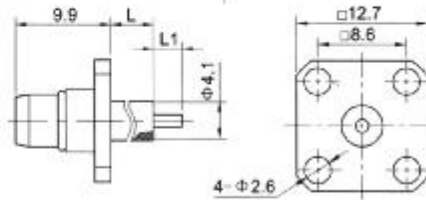

Type	part number	L	L1	Note
BMA-JFD1	0110-0002	84	3	
BMA-JFD3	0110-0004	4	2	
BMA-JFD4	0110-0005	0	3	

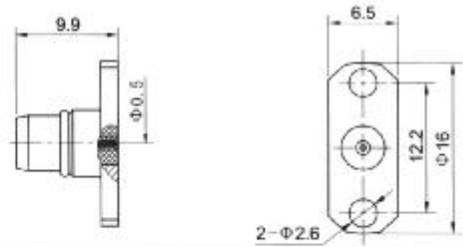

Type	part number	Note
BMA-JFD2	0110-0003	suitable pin 0.5 - 0.02

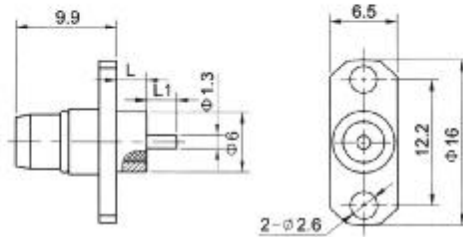

Type	part number	L	L1	Note
BMA-JFD9	0110-0009	5.6	2	
BMA-JFD9A	0110-0010	3.6	3.6	

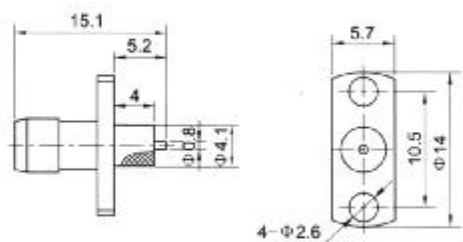

Type	part number	Note
BMA-JFD10	0110-0011	

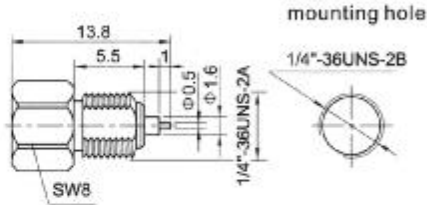

Type	part number	Note
BMA-KYD	0120-2801	

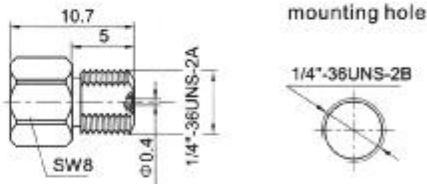

Type	part number	Note
BMA-KYD1	0120-2802	suitable pin 0.4 - 0.08

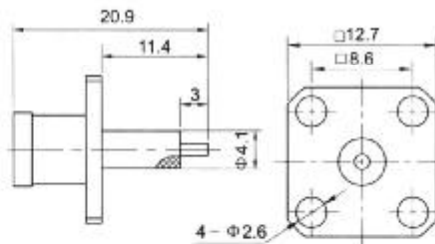

Type	part number	Note
BMA-KFD1	0121-0002	

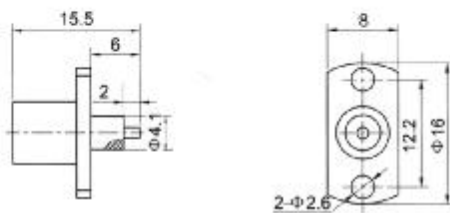

Type	part number	Note
BMA-KFD2	0121-0004	

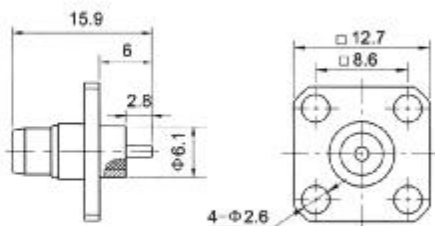

Type	part number	Note
BMA-JFD8G	0114-0003	