

**SERIES SMA  
RF COAXIAL CONNECTORS**

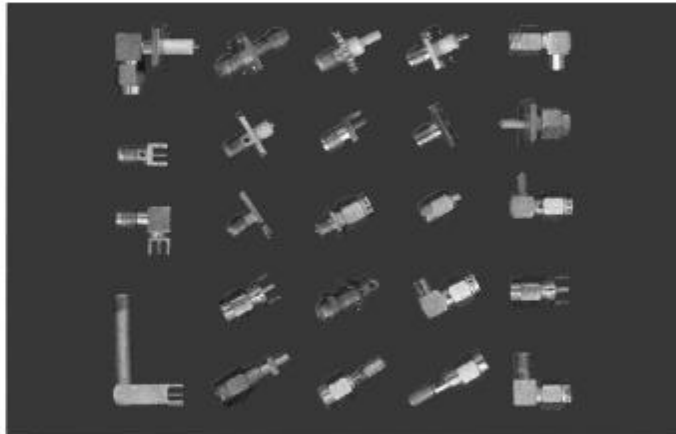

SMA connectors have many advantages, such as small size, wide frequency range, excellent signal properties and high reliability. CERNEXWAVE has a large variety of types along with unique structures and excellent features. SMA connectors are used most widely in the RF and Microwave Industries.

**Key performance**

- Characteristic impedance: 50 Ω
- Frequency range:
  - With flexible cable: 0~12.4GHz
  - With semi-rigid/comfortable cable: 0~18GHz
- Contact resistance:
  - center conductor : ≤3.0m Ω
  - out conductor : ≤2.0m Ω
- Insulation resistance : ≥5000M Ω
- Insulator voltage withstanding : 1000V
- VSWR : with flexiable cable :
  - ≤1.15+0.02f
  - with semi-rigid/flexiable cable:
    - ≤1.10+0.01f
- Connector durability : 500
- Applicable spec/std: MIL-C-39012**

**Material**

- Center contacts:
  - Male---brass, gold plated.
  - Female---beryllium copper, gold plated
- Bodies and other metal parts:
  - brass, gold plated
- Insulators: Teflon
- Crimp ferrule: copper, nickel plated.
- Gasket and seal rings: silicone rubber
- Heat-shrink tubing: thermofit plastic.
- For passivated stainless steel versions, add "G" after the P/N.

**Interface Dimensions**

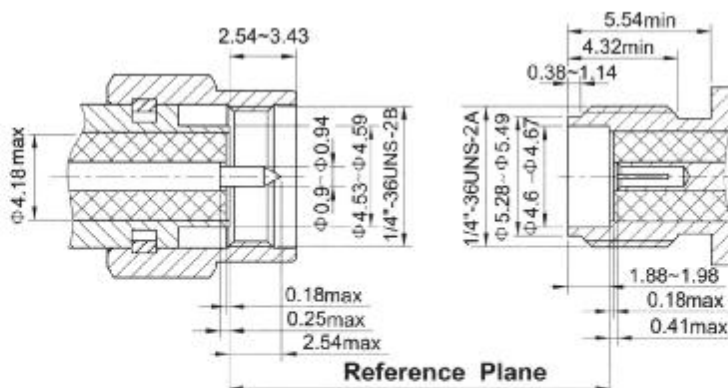

SMA series connectors with semi-rigid/comfortable cable

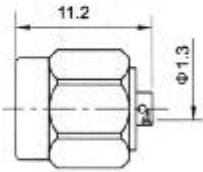

Type	part number	suitable cable	Note
SMA-JB1	0310-6602	B1	

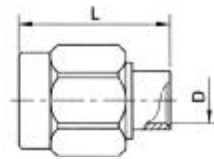

Type	part number	suitable cable	L	D	Note
SMA-JB2	0310-6603	B2	11.2	Φ2.2	
SMA-JB2N	0310-6604	B2	11.2	Φ2.2	coupling nut, nickel plated
SMA-JB2G	0310-6601	B2	11.2	Φ2.2	coupling nut, stainless steel
SMA-JB3	0310-6606	B3	11.2	Φ3.6	
SMA-JB3G	0314-6603	B3	11.2	Φ3.6	
SMA-JB3G1	0314-6605	B3	13.5	Φ3.6	

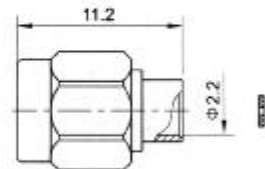

Type	part number	suitable cable	Note
SMA-JB2C	0310-6617	B2	

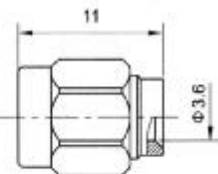

Type	part number	suitable cable	Note
SMA-JB3B	0310-6609	B3	inner of cable is used for center conductors

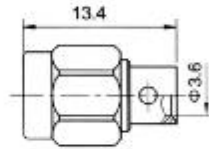

Type part number suitable cable Note

SMA-JB3F	0310-6611	B3
----------	-----------	----

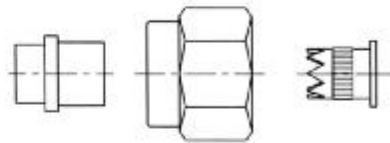

Type part number suitable cable Note

SMA-JB3H	0310-6612	B3	cable used for crimp style
----------	-----------	----	----------------------------

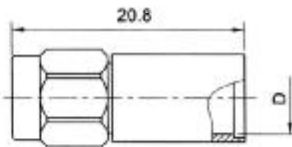

Type part number suitable cable D Note

SMA-JB5	0310-6613	B5	Φ6.1
SMA-JB5A	0310-6613	B5A	Φ6.4

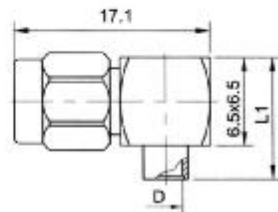

Type part number suitable cable D Note

SMA-JWB2	0330-6601	B2	Φ2.2
SMA-JWB3	0330-6604	B3	Φ3.6

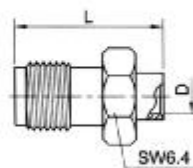

Type part number suitable cable L D Note

SMA-KB2	0320-6602	B2	15	Φ2.2
SMA-KB2A	0320-6605	B2	13.5	Φ2.2
SMA-KB3	0320-6603	B3	15	Φ3.6
SMA-KB5	0320-6604	B5	19.6	Φ6.1
SMA-KB5A	0320-6606	B5A	19.6	Φ6.5

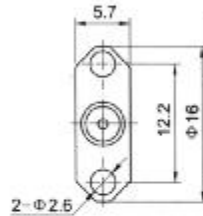
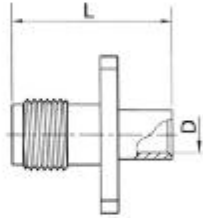

Type	part number	suitable cable	L	D	Note
SMA-KFB2	0320-1604	B2	12	φ2.2	
SMA-KFB2G	0324-1601	B2	12.7	φ2.2	body stainless steel, gold plated
SMA-KFB3	0320-1604	B3	13.1	φ3.6	

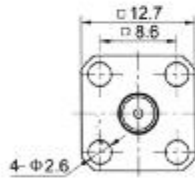
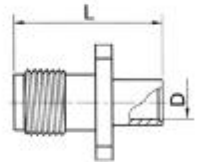

Type	part number	suitable cable	L	D	Note
SMA-KFB2A	0320-1602	B2	13.1	φ2.2	
SMA-KFB2B	0320-1603	B2	14.2	φ2.2	
SMA-KFB3A	0320-1605	B3	13.1	φ3.6	

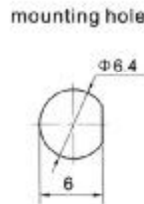
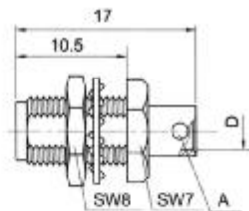

Type	part number	suitable cable	D	d	Note
SMA-KYB2	0320-2602	B2	φ2.2	φ4.4	without solder hole on A
SMA-KYB3	0320-2603	B3	φ3.6	φ5.8	solder hole on A

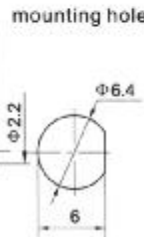
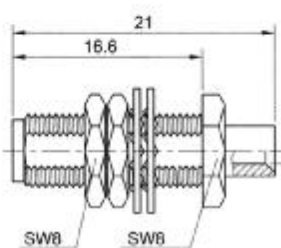

Type	part number	suitable cable	Note
SMA-KYB2B	0320-2603	B2	

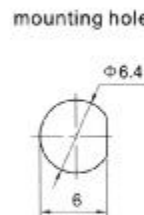
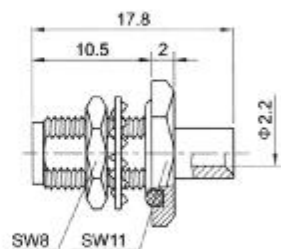

Type	part number	suitable cable	Note
SMA-KYB2C	0320-2607	B2	

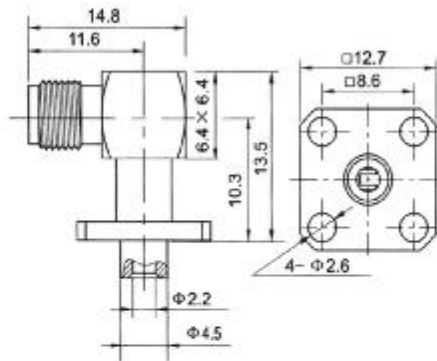

Type	part number	Note
SMA-KWFB2	0340-1802	

## SMA series connectors with flexible cable

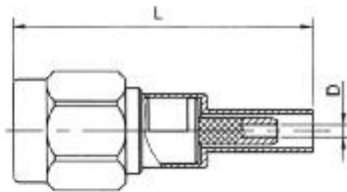

Type	part number	suitable cable	L	D	Note
SMA-J2	0310-6510	2	22.7	Φ0.9	
SMA-JB	0310-6510	3	23.3	Φ1.6	
SMA-JA	0310-6518	4	24.4	Φ2.3	
SMA-JB	0310-6519	4A	27.7	Φ2.3	crimp ferrule, gold plated
SMA-JC	0310-6524	5	27.7	Φ3.1	

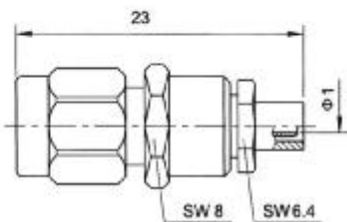

Type	part number	suitable cable	Note
SMA-J2A	0310-6505	2	

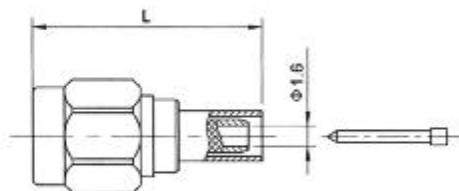

Type	part number	suitable cable	L	Note
SMA-J3	0310-6507	3	18.1	
SMA-J3A	0310-6509	3A	19	
SMA-J3G	0314-6502	3	18.1	coupling nut, stainless steel
SMA-J3N	0311-6501	3	18.1	coupling nut, nickel plated

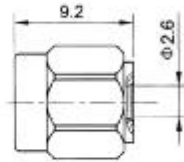

Type	part number	suitable cable	Note
SMA-J3Y	0310-6503	3	extreme short crimp

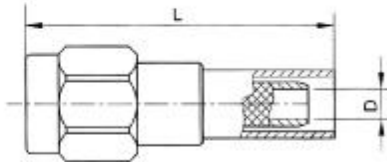

Type	part number	suitable cable	L	D	Note
SMA-J3F	0310-6514	3	25.5	Φ1.6	
SMA-J4	0310-6515	4	23.5	Φ2.3	
SMA-J4-1	0310-6516	4A	23.5	Φ2.3	
SMA-J5	0310-6521	5	25.5	Φ3.1	
SMA-J5A	0310-6522	5A	25.5	Φ3.1	
SMA-J223	0310-6503	RG223	25.5	Φ3.1	

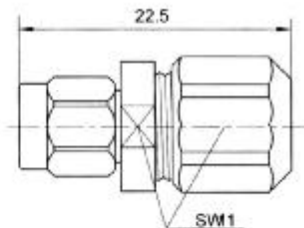

Type	part number	suitable cable	Note
SMA-J4E	0310-6513	4	Clamp

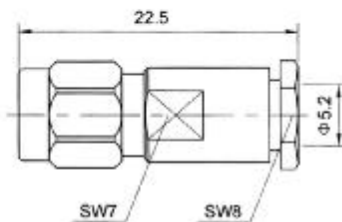

Type	part number	suitable cable	Note
SMA-J5E	0310-6526	5	Clamp

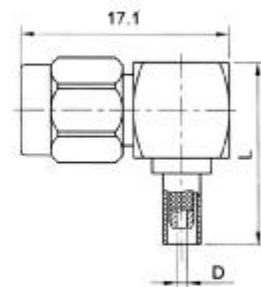

Type	part number	suitable cable	L	D	Note
SMA-JW2	0330-6501	2	13.2	Φ0.9	
SMA-JW3	0330-6502	3	13.8	Φ1.6	
SMA-JW3A	0330-6503	3A	14.7	Φ1.6	
SMA-JW4	0330-6506	4	17.3	Φ2.3	
SMA-JW4-1	0330-6507	4A	17.3	Φ2.3	
SMA-JW5	0330-6508	5	19.3	Φ3.1	
SMA-JW223	0330-6514	RG223	19.3	Φ3.1	
SMA-JW5A	0330-6515	5A	19.3	Φ3.1	

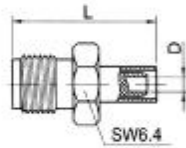

Type	part number	suitable cable	L	D	Note
SMA-K3	0330-6501	3	18.6	Φ1.6	
SMA-K4	0320-6503	4	22	Φ2.3	
SMA-K5	0330-6504	5	24	Φ3.1	
SMA-K5G	0324-6502	5	24	Φ3.1	

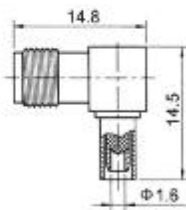

Type	part number	suitable cable	Note
SMA-KW3	0324-6501	3	

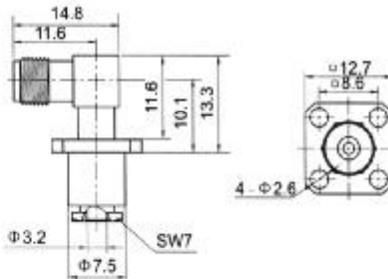

Type	part number	suitable cable	Note
SMA-KWF3	0340-1501	3	

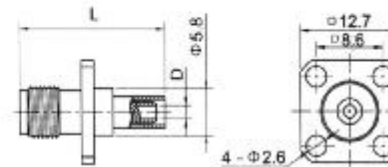

Type	part number	suitable cable	L	D	Note
SMA-KF3	0320-2505	3	18.5	Φ1.6	
SMA-KF3B	0320-1505	3A	18.5	Φ1.6	crimp ferrule, gold plated
SMA-KF4	0320-1503	4	21.9	Φ2.3	
SMA-KF5	0320-2513	5	24	Φ3.1	

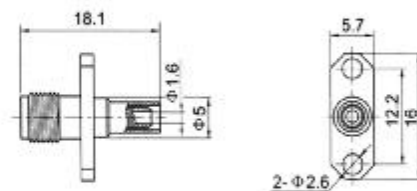

Type	part number	suitable cable	Note
SMA-KF3A	0320-1502	3	

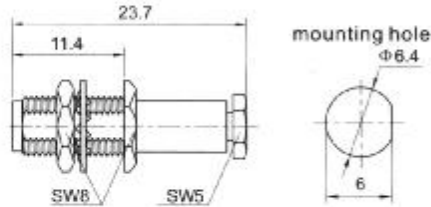

Type	part number	suitable cable	Note
SMA-KY1	0320-2502	0.4	

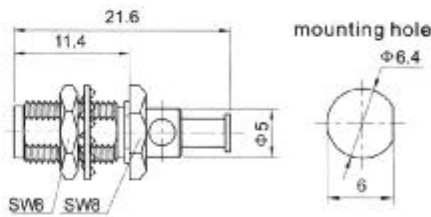

Type	part number	suitable cable	Note
SMA-KY2A	0320-2504	2	
SMA-KY0.8	0320-2501	0.8	

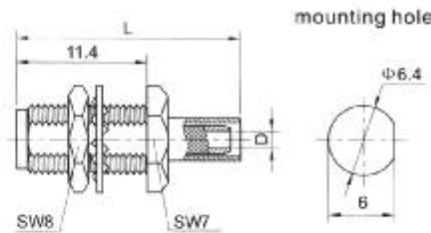

Type	part number	suitable cable	L	D	Note
SMA-KY3	0320-2505	3	19.9	Φ1.6	
SMA-KY4	0320-2512	4	23.3	Φ2.3	
SMA-KY5	0320-2513	5	25.3	Φ3.1	
SMA-KY5A	0320-2514	5A	25.3	Φ3.1	

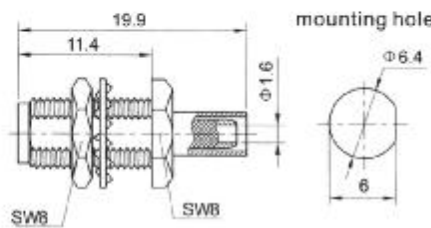

Type	part number	suitable cable	Note
SMA-KY3C	0320-2507	3	

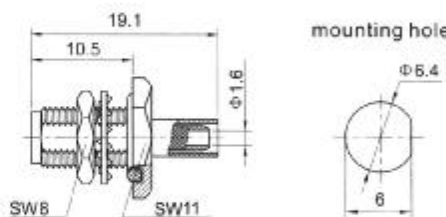

Type	part number	suitable cable	Note
SMA-KY3E	0324-2509	3	stainless steel body
SMA-KY3G	0324-2501	3	nut copper, nickel plated



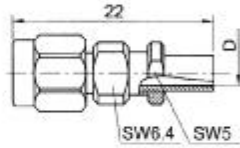

Type	part number	suitable cable	D	Note
SMA-J613	0320-0529	613	Φ4.4	
SMA-J3DG	0314-6051	Flex 405	Φ2.4	
SMA-J5FG	0314-6505	Flex 402	Φ3.8	stainless steel body/nut

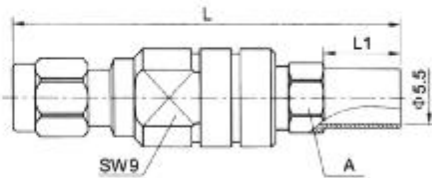

Type	part number	suitable cable	L	L1	A	Note
SMA-J615	0310-6531	615	44.4	8.7	SW8	
SMA-J615G	0314-6506	615	32.2	0	SW9	stainless steel body/nut

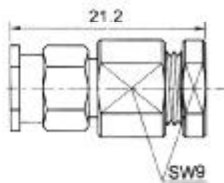

Type	part number	suitable cable	Note
SMA-J617G	0314-6509	617	

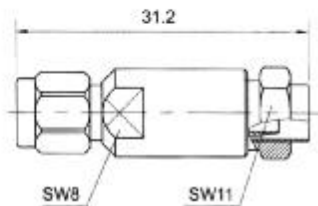

Type	part number	suitable cable	Note
SMA-J623G	0314-6507	623	

SMA series connectors with PCB mounting

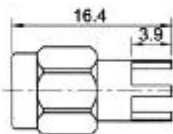

mounting hole

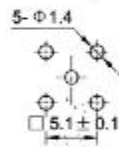

Type	part number	Note
------	-------------	------

SMA-JHD	0310-5801	
---------	-----------	--

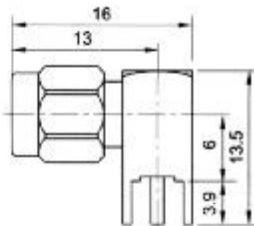

mounting hole

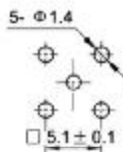

Type	part number	Note
------	-------------	------

SMA-JWHD	0330-5803	
----------	-----------	--

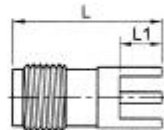

mounting hole

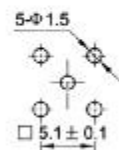

Type	part number	L	L1	Note
------	-------------	---	----	------

SMA-KHD	0320-5801	13.5	3.9	
---------	-----------	------	-----	--

SMA-KHD13	0320-5814	12.1	2.8	
-----------	-----------	------	-----	--

SMA-KHD14	0320-5815	15.5	2.9	
-----------	-----------	------	-----	--

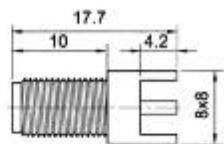

mounting hole

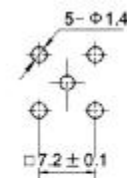

Type	part number	Note
------	-------------	------

SMA-KHD1	0320-5802	
----------	-----------	--

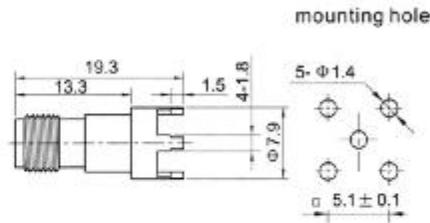

Type	part number	Note
SMA-KHD11	0320-5812	

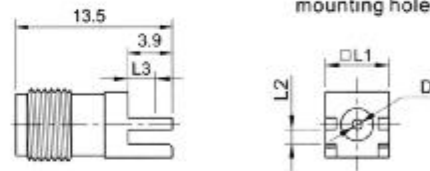

Type	part number	L1	L2	L3 (center conductor length)	d
SMA-KHD2	0320-5803	6.1	1.5	3.9	Φ1.3
SMA-KHD3	0320-5804	6.7	2.2	3.9	Φ0.8
SMA-KHD5	0320-5806	6.7	2	3.9	Φ0.8
SMA-KHD12	0320-5813	6.7	2.5	2.5	Φ0.3

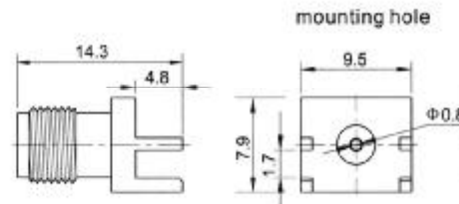

Type	part number	Note
SMA-KHD4	0320-5805	

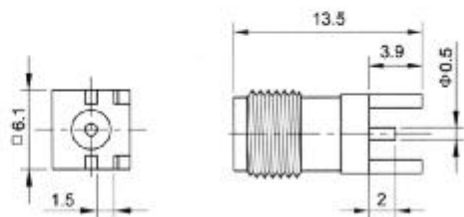

Type	part number	Note
SMA-KHD6	0320-5805	

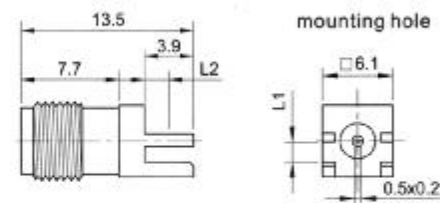

Type	part number	L1	L2 (center conductor length)	Note
SMA-KHD9	0320-5810	1.6	2	
SMA-KHD19	0320-5820	1.0	3.9	

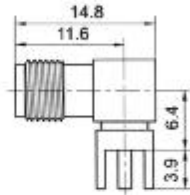

mounting hole

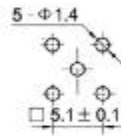

Type	part number	suitable cable	Note
SMA-KWHD	0340-5801	3	

## SMA series connectors with micro-belt

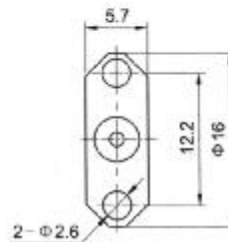
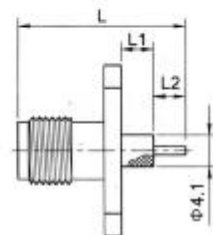

Type	part number	L	L1	L2	Note
SMA-KFD3	0320-0005	27.4	15	3	
SMA-KFD5A	0320-0007	17.5	4	4	
SMA-KFD21	0320-0020	15.5	2	4	
SMA-KFD46	0320-0040	16.5	4	3	
SMA-KFD57	0320-0046	17.4	4.8	3	
SMA-KFD84	0320-0057	15.6	3	3	
SMA-KFD102	0320-0066	17.6	5	3	
SMA-KFD302	0320-0077	15.6	4.1	2	
SMA-KFD311	0320-0085	17.5	4.5	3.5	
SMA-KFD312	0320-0086	20.5	8	3	
SMA-KFD328G	0320-0007	14.9	3.2	1.3	
SMA-KFD339	0320-0107	16.5	5	2	
SMA-KFD342	0320-0111	37	24.5	3	
SMA-KFD348	0320-0117	11.5	0	2	
SMA-KFD376	0320-0139	21	8.3	3.2	
SMA-KFD384	0320-0147	17.8	3.2	5.1	
SMA-KFD385	0320-0148	17.8	5	3.3	
SMA-KFD386	0320-0149	19.4	6.1	3.8	
SMA-KFD393	0320-0156	16.5	5	2	
SMA-KFD395	0320-0158	17.3	6.3	1.5	

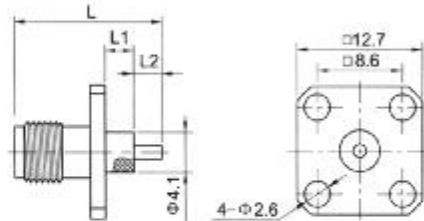

Type	part number	L	L1	L2	Note
SMA-KFD5	0320-0006	15.5	4	2	
SMA-KFD6	0320-0008	20.5	9	2	
SMA-KFD22	0320-0021	27.4	15	3	
SMA-KFD43	0320-0039	21.5	4	8	
SMA-KFD83	0320-0066	14.5	2.5	2.5	
SMA-KFD85	0320-0058	27.4	13	5	
SMA-KFD85A	0320-0159	25.5	13	3	
SMA-KFD227	0320-0071	18.6	5	4	
SMA-KFD228	0320-0072	20.6	5	3	
SMA-KFD246	0320-0074	17.5	4	4	
SMA-KFD307	0320-0082	17.1	5	2.5	
SMA-KFD347	0320-0116	20.5	4	7	
SMA-KFD359	0320-0125	18	4	4.5	
SMA-KFD390	0320-0153	16	5	1.5	
SMA-KFD411	0320-0173	22	1.5	11	body nickel plated
SMA-KFD413	0320-0175	18	5.5	3	
SMA-KFD414	0320-0176	25.3	8.1	7.7	
SMA-KFD415	0320-0177	27.4	15	2.9	

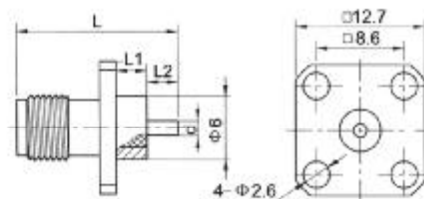

Type	part number	L	L1	L2	d	Note
SMA-KFD19	0320-0017	4	4.0	2.0	φ1.3	
SMA-KFD76	0320-0180	14	3	1.5	φ0.7	
SMA-KFD95	0320-0063	15.1	4.0	1.5	φ0.8	
SMA-KFD369	0320-0132	24.3	12.8	2	φ1.3	
SMA-KFD372	0320-0136	28.4	4.0	15	φ1.3	
SMA-KFD377	0320-0140	15.6	3	3	φ1.3	
SMA-KFD401	0320-0164	15.8	4.3	2	φ1.3	

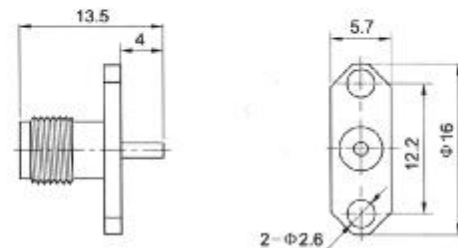

Type	part number	Note
SMA-KFD20	0320-0019	

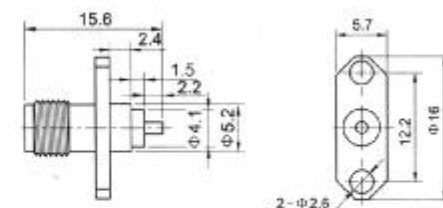

Type	part number	Note
SMA-KFD24	0320-0023	

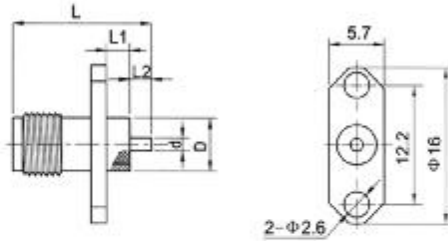

Type part number L L1 L2 d D D1 Note

SMA-KFD24A	0320-0024	14.7	3	2.2	Φ1.3	Φ5.2	Φ5.4
SMA-KFD19A	0320-0018	15.5	4	2	Φ1.3	Φ6	Φ6.1
SMA-KFD404	0320-0167	14.5	4	1	Φ0.8	Φ4	Φ4.2

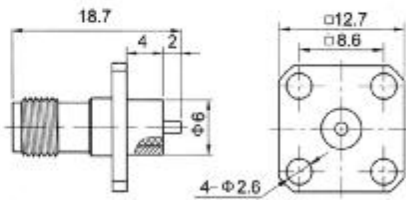

Type part number Note

SMA-KFD383	0320-0146
------------	-----------

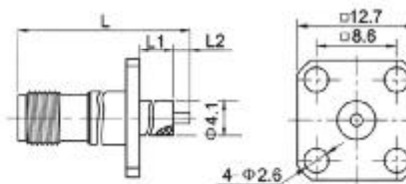

Type part number L L1 L2 Note

SMA-KFD392	0320-0155	41.2	15.5	2
SMA-KFD417	0320-0179	38	12.5	1.5

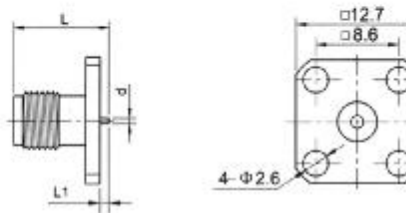

Type part number L L1 d D Note

SMA-KFD48A	0320-0042	10.3	0.9	Φ0.6	Φ1.4	
SMA-KFD68	0320-0061	14.1	1.5	Φ0.5	Φ1.2	
SMA-KFD380	0320-0143	10.3	0.9	Φ0.6	Φ1.4	
SMA-KFD380G	0324-0018	10.3	0.9	Φ0.6	Φ1.4	stainless steel body

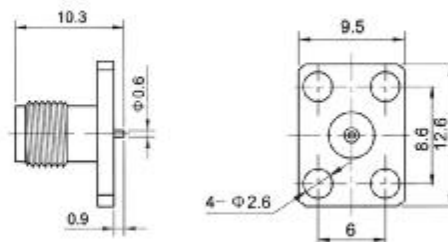

Type part number Note

SMA-KFD48B	0320-0043
------------	-----------

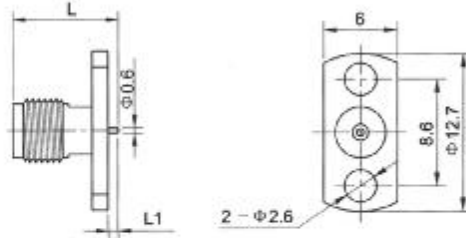

Type	part number	L	L1	Note
SMA-KFD48C	0320-0044	10.3	0.9	
SMA-KFD340	0320-0108	11	1.5	

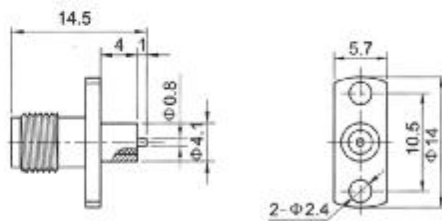

Type	part number	Note
SMA-KFD412N	0321-0001	body nickel plated

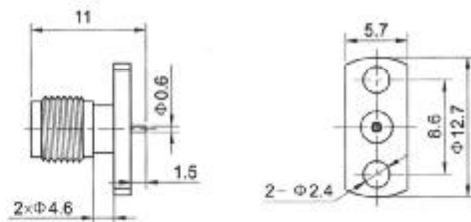

Type	part number	Note
SMA-KFD345	0320-0114	

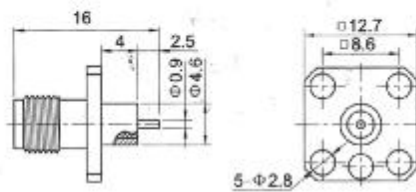

Type	part number	Note
SMA-KFD350G	0324-0013	stainless steel gold plated

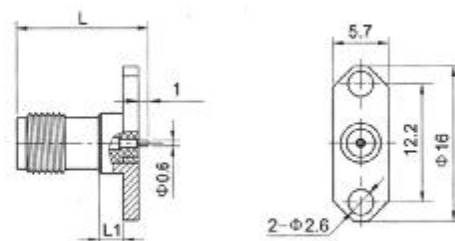

Type	part number	L	L1	Note
SMA-KFD397	0320-0160	10.5	0	
SMA-KFD398	0320-0161	13.5	2.5	

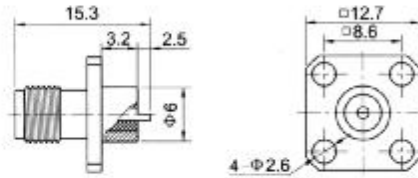

Type	part number	Note
SMA-KFD90	0320-0062	

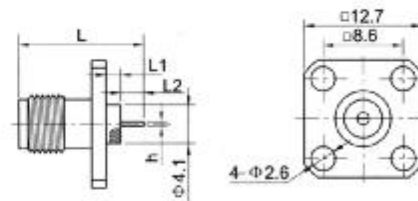

Type	part number	L	L1	L2	h	Note
SMA-KFD13	0320-0014	16.1	4.0	2.6	0.5×0.2	
SMA-KFD39	0320-0034	12.1	0	2.6	0.5×0.2	
SMA-KFD335	0320-0103	13	2	1.5	1×0.2	
SMA-KFD32	0320-0030	16.1	0	2.5	1.3×0.2	
SMA-KFD39A	0320-0035	12.1	0	2.6	1×0.2	
SMA-KFD253	0320-0075	15.7	3.2	3	1.3×0.2	

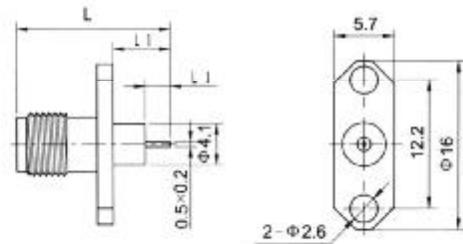

Type	part number	L	L1	L2	Note
SMA-KFD98	0320-0064	15.2	5.7	2.5	flat perpendicular to long side
SMA-KFD389	0320-0152	16	6.5	2.5	flat parallelism with long side

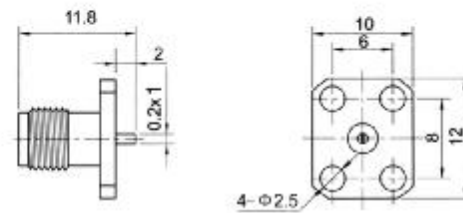

Type	part number	Note
SMA-KFD387	0320-0150	flat parallelism with long side

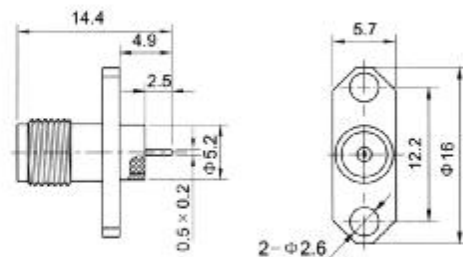

Type	part number	Note
SMA-KFD31	0320-0029	flat parallelism with long side



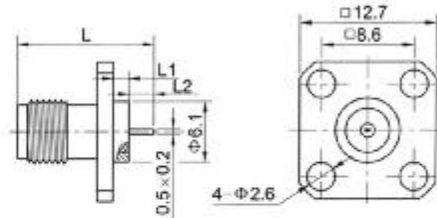

Type	part number	L	L1	L2	Note
SMA-KFD10	0320-0011	15.3	3.2	2.5	
SMA-KFD11	0320-0012	16.9	4.8	2.5	
SMA-KFD12	0320-0013	16.1	4	2.5	
SMA-KFD316	0320-0091	17	6	1.5	

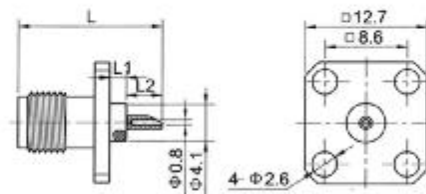

Type	part number	L	L1	L2	Note
SMA-KFD	0320-0002	14.7	0	5.1	
SMA-KFD65	0320-0047	12.5	0	3.0	
SMA-KFD40	0320-0037	16.5	4	3	
SMA-KFD361	0320-0128	16.5	4	3	
SMA-KFD40A	0320-0038	16.5	5.5	1.5	

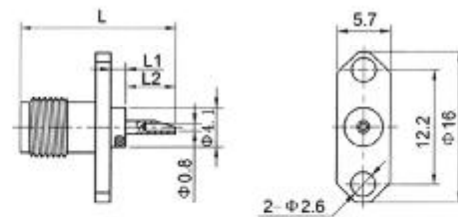

Type	part number	L	A	B	Note
SMA-KFD86	0320-0060	14.5	0	5.1	
SMA-KFD100	0320-0065	16.5	4	3	
SMA-KFD353	0320-0119	17.5	5	3	
SMA-KFD17	0320-0001	14.6	1.1	4	
SMA-KFD312A	0320-0087	20.5	8	3	stainless steel gold plated

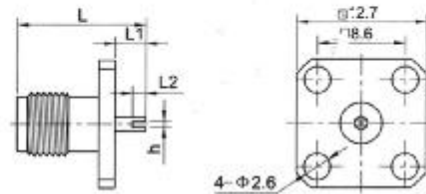

Type	part number	L	L1	L2	h	Note
SMA-KFD1	0320-0003	17.5	8.0	1.4	0.6	groove tail of center conductor
SMA-KFD35	0320-0032	10.6	1.0	1.0	0.4	groove tail of center conductor

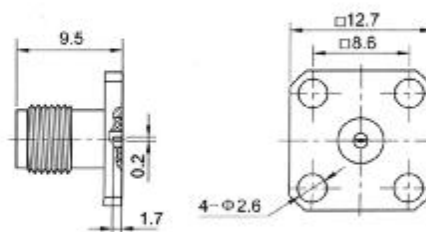

Type	part number	Note
SMA-KFD26	0320-0025	groove tail of center conductor

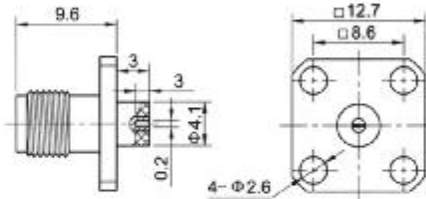

Type	part number	Note
SMA-KFD28	0320-0027	groove tail of center conductor

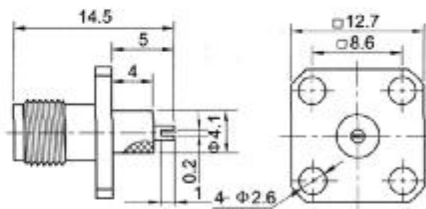

Type	part number	Note
SMA-KFD37	0320-0033	

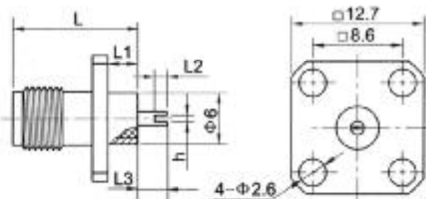

Type	part number	L	L1	L2	L3	h	Note
SMA-KFD34	0320-0031	10.5	1	1.0	1	0.4	
SMA-KFD305	0320-0080	13.6	4	1.5	0	0.2	

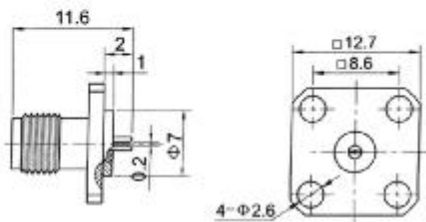

Type	part number	Note
SMA-KFD332	0320-0101	

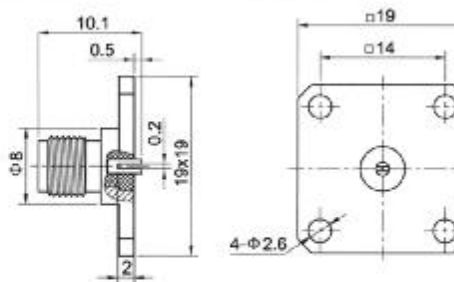
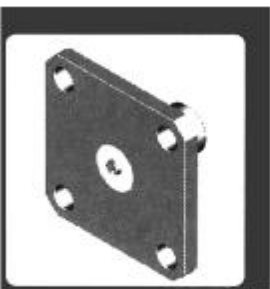

Type	part number	Note
SMA-KFD407	0320-0170	

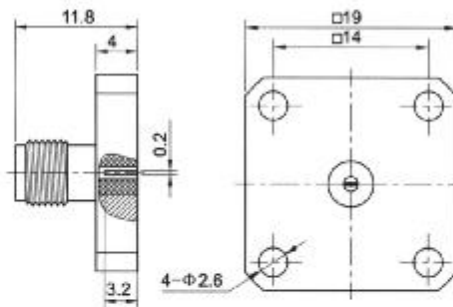

Type	part number	Note
SMA-KFD394	0320-0157	

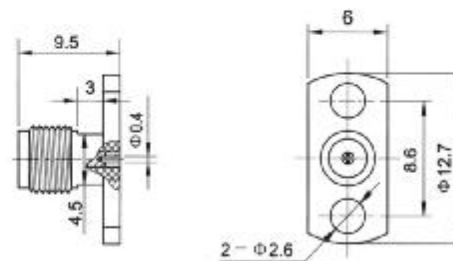

Type	part number	Note
SMA-KFD72A	0320-0049	suitable pin $\Phi 0.4$ $^{+0.01}_{-0.02}$
SMA-KFD364	0320-0130	suitable pin $\Phi 0.4$ $^{+0.04}_{-0.02}$
SMA-KFD364G	0324-0014	stainless steel body

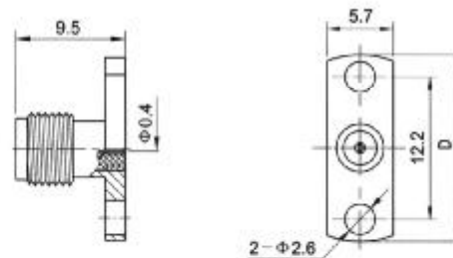

Type	part number	h	D	Note
SMA-KFD72	0320-0050	12.2	$\Phi 16$	suitable pin $\Phi 0.4$ $^{+0.01}_{-0.02}$
SMA-KFD337G	0324-0011	10.2	$\Phi 14$	suitable pin $\Phi 1.4$ $^{+0.01}_{-0.02}$ stainless steel body

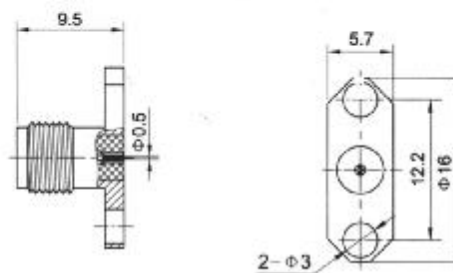

Type	part number	Note
SMA-KFD331G	0324-0010	stainless steel body suitable pin $\Phi 6.5$ $^{+0.03}_{-0.02}$

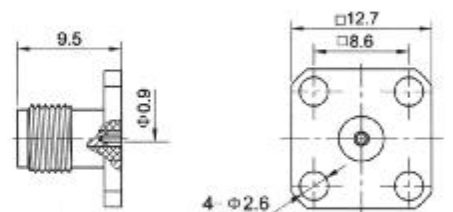

Type	part number	Note
SMA-KFD92	0320-0045	suitable pin $\Phi 0.5$ $^{+0.04}_{-0.02}$

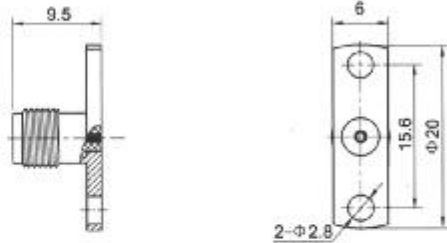

Type	part number	Note
SMA-KFD356	0320-0122	suitable pin $\Phi 0.4^{+0.02}$

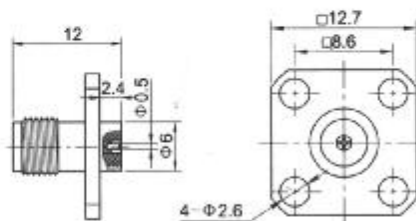

Type	part number	Note
SMA-KFD308	0320-0063	suitable pin $\Phi 0.4^{+0.02}$

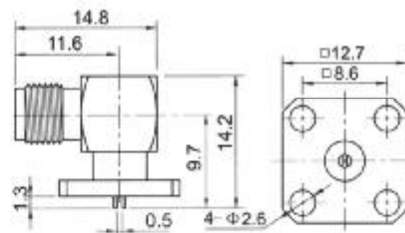

Type	part number	Note
SMA-KWFD	0340-0001	

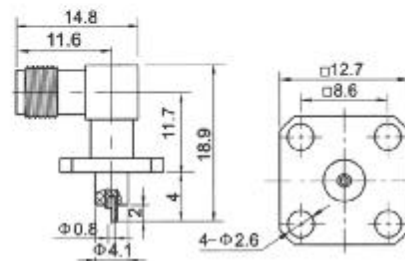

Type	part number	Note
SMA-KWFD1	0340-0002	

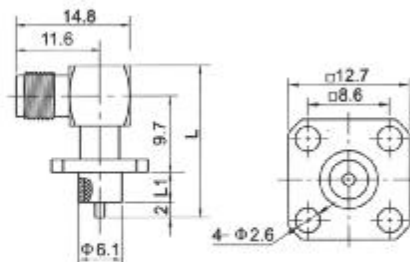

Type	part number	L	L1	Note
SMA-KWFD2	0340-0003	18.9	4	
SMA-KWFD18	0340-0111	27.7	12.8	

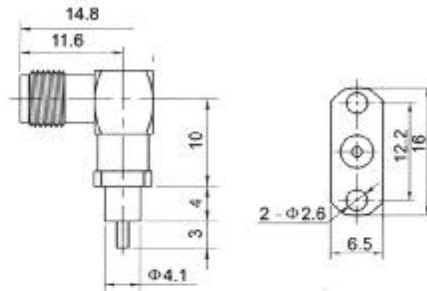

Type	part number	Note
------	-------------	------

SMA-KWFD11	0340-0004	
------------	-----------	--

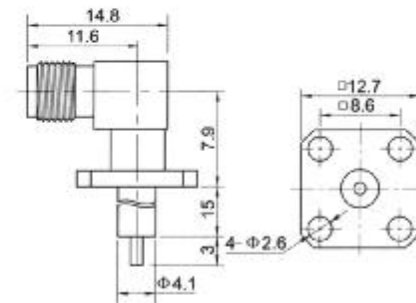

Type	part number	Note
------	-------------	------

SMA-KWFD12G	0340-0005	stainless steel body
-------------	-----------	----------------------

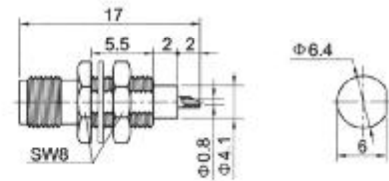

Type	part number	Note
------	-------------	------

SMA-KYD	0320-2801	
---------	-----------	--

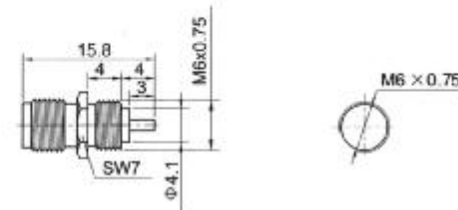

Type	part number	Note
------	-------------	------

SMA-KYD1	0320-2802	
----------	-----------	--

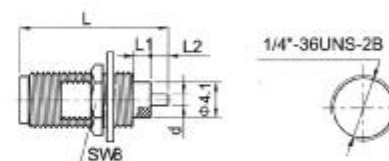

Type	part number	L	L1	L2	d	Note
------	-------------	---	----	----	---	------

SMA-KYD2	0320-2803	16.7	2	2	φ1.3	
SMA-KYD19	0320-2809	16.7	2	2	φ0.5	no nut/gasket
SMA-KYD30	0320-2815	18.1	1.8	1.8	φ1.3	

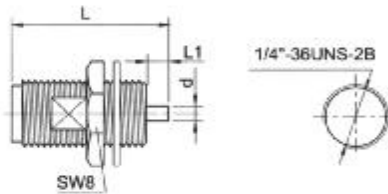

Type	part number	L	L1	d	Note
SMA-KYD5	0320-2805	24.9	2.9	Φ1.3	
SMA-KYD18	0320-2808	15.6	3	Φ0.5	no nut/gasket
SMA-KYD22	0320-2812	12	1.5	Φ1	no nut/gasket
SMA-KYD20	0320-2810	18	2	Φ1.3	
SMA-KYD32	0320-2823	25.7	13	Φ2	no nut/gasket
SMA-KYD34	0320-2825	16.7	2	Φ1.3	
SMA-KYD35	0320-2826	19.5	2.5	Φ1.3	no nut/gasket

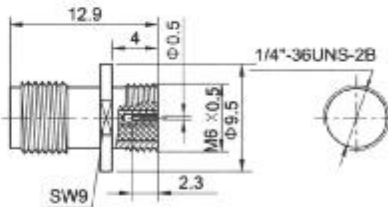

Type	part number	Note
SMA-KYD17	0320-2807	suitable pin Φ0.4 <sup>+0.02</sup> / <sub>-0.02</sub>

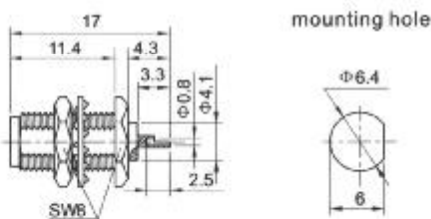

Type	part number	Note
SMA-KYD21	0320-2811	

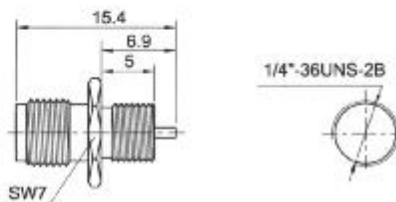

Type	part number	Note
SMA-KYD31A	0320-2817	

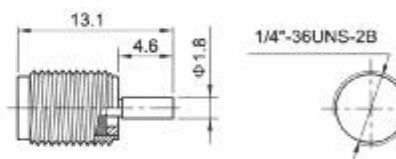

Type	part number	Note
SMA-KYD29G	0324-2801	stainless steel body

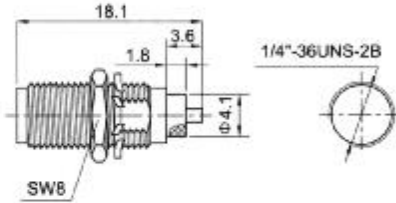

Type	part number	Note
SMA-KYD30	0320-2815	

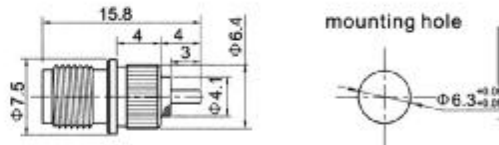

Type	part number	Note
SMA-KPD1	0320-3801	

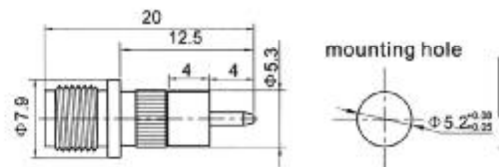

Type	part number	Note
SMA-KPC3	0320-3803	

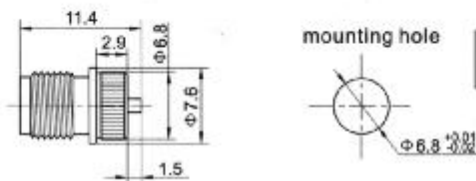

Type	part number	Note
SMA-KPD5G	0324-3801	stainless steel body

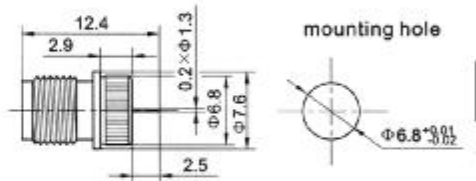

Type	part number	Note
SMA-KPD6G	0324-3802	stainless steel body

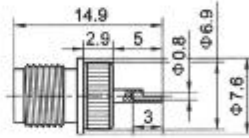

mounting hole

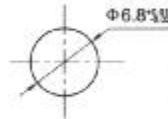

Type	part number	Note
------	-------------	------

SMA-KPD7G	0324-3803	stainless steel body
-----------	-----------	----------------------

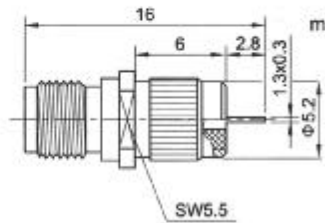

mounting hole

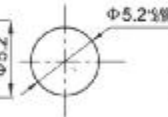

Type	part number	Note
------	-------------	------

SMA-KPD9-2	0320-3808	stainless steel body
------------	-----------	----------------------

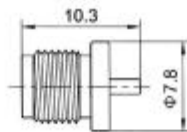

Type	part number	Note
------	-------------	------

SMA-KD1	0320-0802	
---------	-----------	--

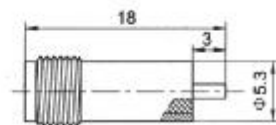

Type	part number	Note
------	-------------	------

SMA-KD2	0320-6803	
---------	-----------	--

SMA adapters



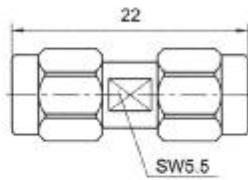

Type	part number	Note
SMA-JJ	0300-6901	
SMA-JJG	0304-6902	stainless steel body/nut

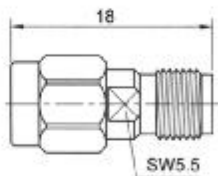

Type	part number	Note
SMA-JK	0300-6902	
SMA-JKG	0304-6901	stainless steel body/nut

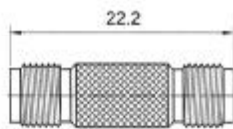

Type	part number	Note
SMA-KK1	0300-6907	
SMA-KK1G	0304-6903	stainless steel body

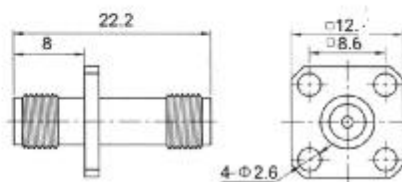

Type	part number	Note
SMA-KFK1	0300-1901	
SMA-KFK1G	0304-1902	stainless steel body

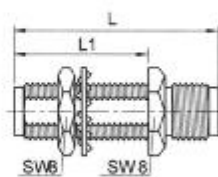

mounting hole



Type	part number	L	L1	Note
SMA-KYK	0300-2901	22.2	14.6	
SMA-KYK2	0300-2903	18	102	
SMA-KYKG	0304-2901	22.2	14.6	stainless steel body

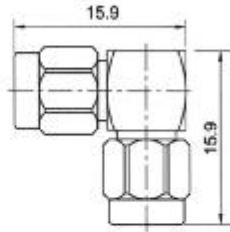

Type	part number	Note
SMA-JWJ	0300-6910	

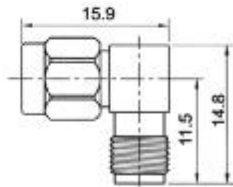

Type	part number	Note
SMA-JWK	0300-6911	

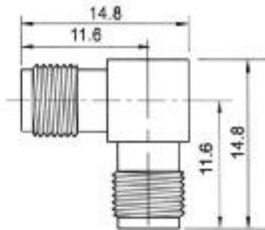

Type	part number	Note
SMA-KWK	0300-6909	

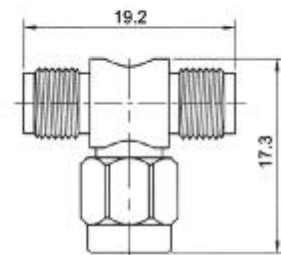

Type	part number	Note
SMA-KJK	0300-6905	

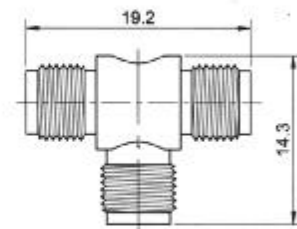

Type	part number	Note
SMA-KKK	0300-6908	