

**SERIES N  
RF COAXIAL CONNECTORS**

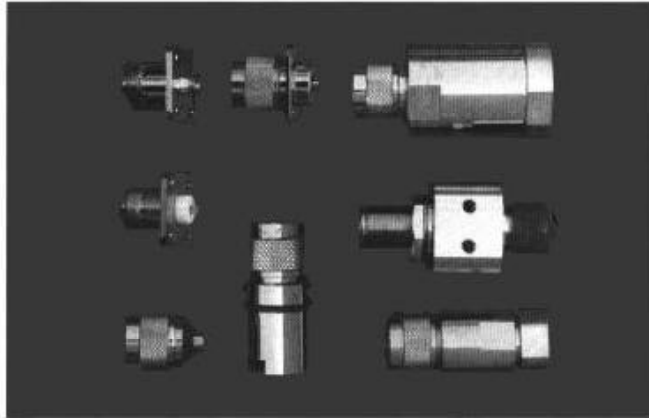

Series N connectors are screw-type coupling and provide sturdy reliable connection. The N connectors are available for flexible, semi-rigid and corrugated cables as well as bulkhead and panel versions.

**Key performance**

- Characteristic Impedance : 50 Ω
- Frequency range : 0~11GHz
- Contact resistance :
  - Center conductor ≤ 1.5m Ω
  - Out conductor ≤ 0.2m Ω
- Insulation resistance : ≥ 5000M Ω
- Insulator voltage withstanding : 1500V
- VSWR : ≤ 1.30
- Connector durability : 500 cycles
- Applicable spec/std** : MIL-C-39012

**Material**

- Center contacts:
  - Male---brass, gold plated.
  - Female---phosphor bronze, gold plated
- Bodies and other metal parts:
  - brass, nickel plated
- Insulators: Teflon
- Crimp ferrule: copper, nickel plated.
- Gasket and seal rings: silicone rubber
- Heat-shrink tubing: thermofit plastic

**Interface Dimensions**

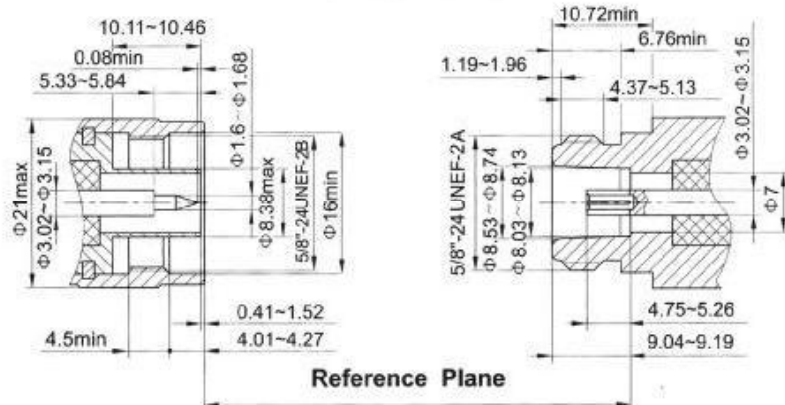

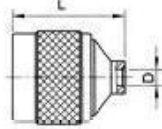

Type	part number	suitable cable	L	D	Note
N-JB3	0611-6601	B3	24	Φ3.6	coupling nut, nickel plated, body, silver plated
N-JB3B	0611-6603	B3	24	Φ3.6	all of SUCCO plated
N-JB3G	0614-6601	B3	24	Φ3.6	coupling nut, nickel plated, body, silver plated
N-JB5A	0611-6607	B5A	26.4	Φ6.4	coupling nut, nickel plated, body nickel plated, solder part, gold plated

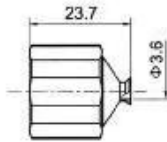

Type	part number	suitable cable	Note
N-JB3A	0611-6602	B3	body, silver plated

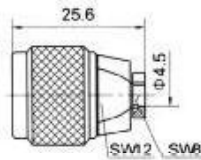

Type	part number	suitable cable	Note
N-JB3D	0611-6608	B3	

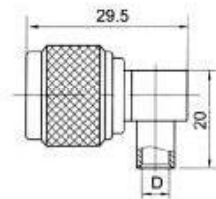

Type	part number	suitable cable	D	Note
N-JWB3	0631-6601	B3	Φ3.6	
N-JWB5A	0631-6602	B5A	Φ6.4	

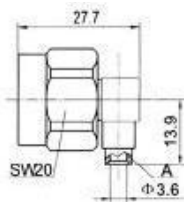

Type	part number	Note
N-JWB3A	0631-0064	A gold plated, others, SUCCO plated

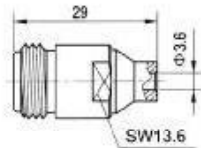

Type part number suitable cable Note

N-KB3 0621-6601 B3

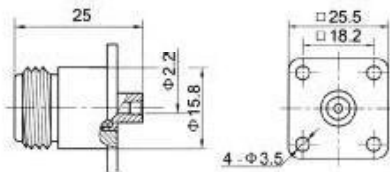

Type part number suitable cable Note

N-KFB2A 0621-1602 B2 only soldering part, gold plated.

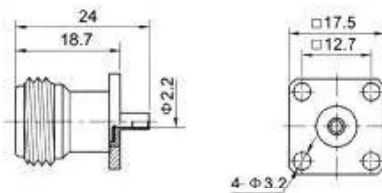

Type part number suitable cable Note

N-KFB2B 0621-1603 B2 only soldering part, gold plated.

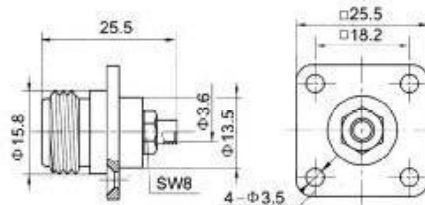

Type part number suitable cable Note

N-KFB3A 0621-1606 B3 only soldering part, gold plated.

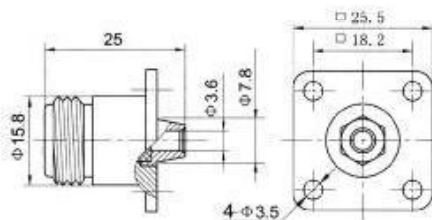

Type part number suitable cable Note

N-KFB3B 0621-1607 B3 only soldering part, gold plated.

# N SERIES

# CERNEXWAVE

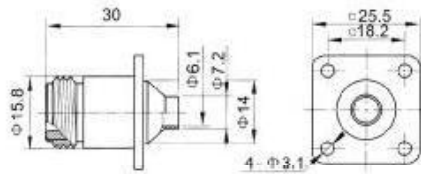

Type	part number	suitable cable	Note
N-KFB5-1	0621-1609	B5	thead front was rivet, gold plated. body, gold plate

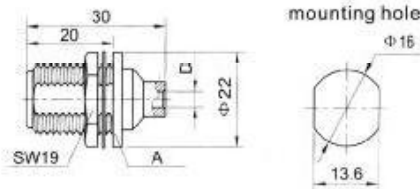

Type	part number	suitable cable	D	Note
N-KYB3	0621-2601	B3	Φ3.6	
N-KYB5	0621-2606	B5	Φ6.1	
N-KYB3C	0621-2604	B3	Φ3.6	seal rings of A

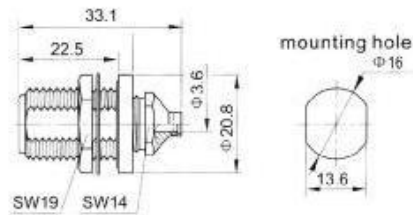

Type	part number	suitable cable	Note
N-KYB3B	0621-2603	B3	

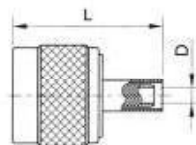

Type	part number	suitable cable	L	D	Note
N-JY	0611-6502	4	29.7	Φ2.3	
N-J5Y	0611-6505	5	29.2	Φ3.1	
N-J5YA	0611-6529	5A	29.2	Φ3.1	
N-J6YA	0611-6510	6	34.3	Φ4.8	

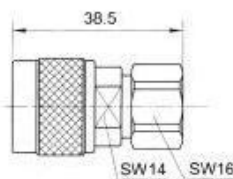

Type	part number	suitable cable	Note
N-J5A	0611-6503	5	
N-J7A	0611-6511	7	
N-J8A	0611-6513	8	
N-J103	0611-6526	103	

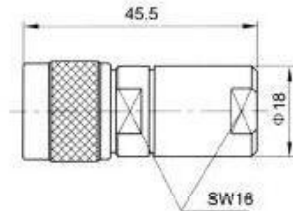

Type part number suitable cable Note

N-J631	0611-6535	7DFB	
N-J635	0611-6541	8DFB	

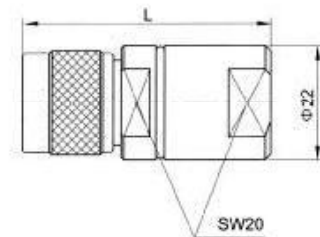

Type part number suitable cable L Note

N-J632	0611-6536	10DFB	45.6
N-J636	0611-6542	12DFB	44.5

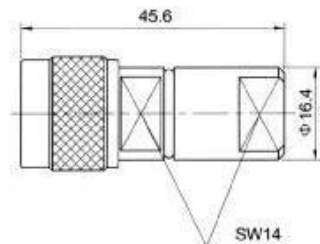

Type part number suitable cable L Note

N-J634	0611-6540	5DFB	45.6
--------	-----------	------	------

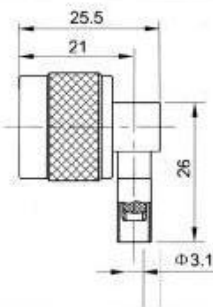

Type part number suitable cable Note

N-JWSY	0631-6502	5	
N-JWSYA	0631-6503	5A	

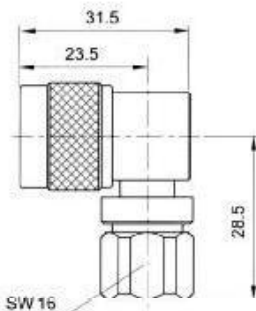

Type part number suitable cable Note

N-JW7A	0631-6505	7	
--------	-----------	---	--

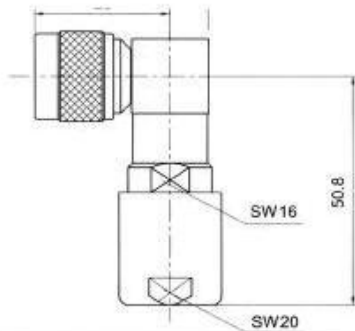

Type	part number	suitable cable	Note
N-JWA	0631-6507	9	

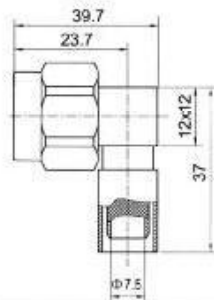

Type	part number	suitable cable	Note
N-JWEY	0631-6506		SUCO plated
N-JW213	0631-6510		compages body silver plated coupling nut, nickel plated

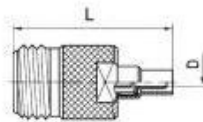

Type	part number	suitable cable	L	D	Note
N-K3Y	0621-6502	3	34.5	Φ1.6	
N-K5Y	0621-6503	5	34	Φ3.1	
N-K6Y	0621-6508	6	42	Φ4.8	

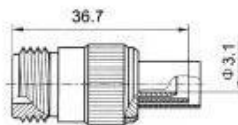

Type	part number	suitable cable	Note
N-K5YA	0621-6504	5	

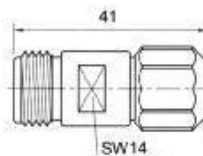

Type	part number	suitable cable	Note
N-K6YA	0624-6509	6	
N-K7A	0624-6510	7	

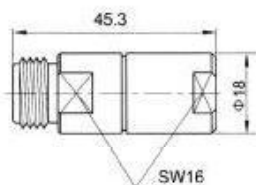

Type part number suitable cable Note

N-K631	0621-6516	7D-FB	
N-K635	0621-6520	8D-FB	

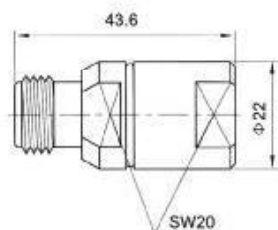

Type part number suitable cable Note

N-K632	0621-6518	10D-FB	
N-K636	0621-6521	12D-FB	

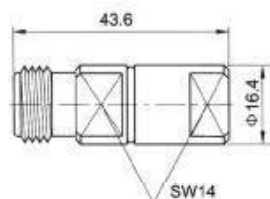

Type part number suitable cable Note

N-K634	0621-6519	5D-FB	
--------	-----------	-------	--

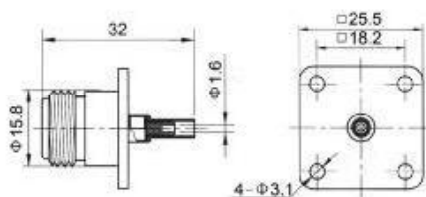

Type part number suitable cable Note

N-KF3Y	0621-1501	3	
--------	-----------	---	--

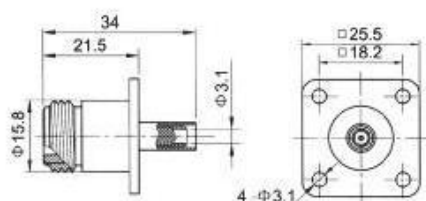

Type part number suitable cable Note

N-KF5Y	0621-1504	5	
--------	-----------	---	--

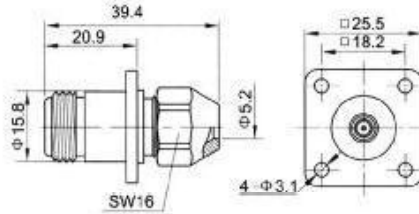

Type	part number	suitable cable	Note
N-KF5A	0621-1906	5	

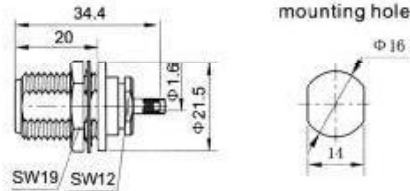

Type	part number	suitable cable	Note
N-KY3Y	0621-6507	3	

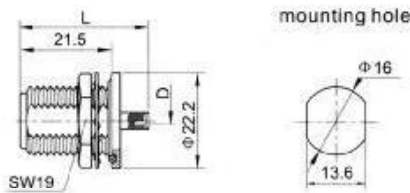

Type	part number	suitable cable	L	D	Note
N-KY3YA	0621-2503	3A	31	Φ1.6	
N-KY3YA-1	0621-2504	3A	30	Φ1.6	Crimp ferrule gold plated

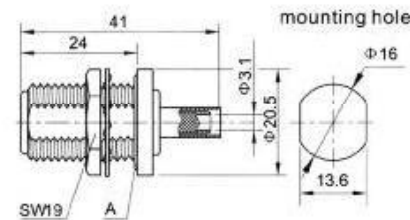

Type	part number	suitable cable	Note
N-KY5Y	0621-2507	5	seal rings on A
N-KY5YA	0621-2508	5A	no seal rings on A
N-KY5YB	0621-2509	5	no seal rings on A

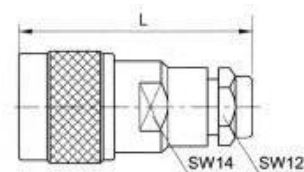

Type	part number	suitable cable	L	Note
N-J501	0611-6701	501	38.1	center conductor solder
N-J503	0611-6705	503	44.9	center conductor without solder



# N SERIES

# CERNEXWAVE

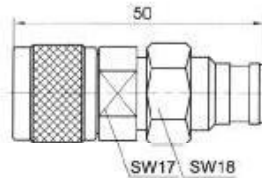

Type	part number	suitable cable	Note
N-J511	0611-6706	511	center conductor, solder

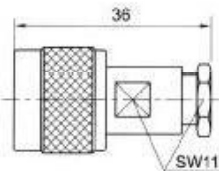

Type	part number	suitable cable	Note
N-J513	0611-6707	513	center conductor, without solder

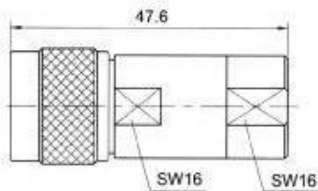

Type	part number	suitable cable	Note
N-J514	0611-6708	514	center conductor, without solder
N-J522	0611-6709	522	center conductor, without solder
N-J524	0611-6710	524	center conductor, without solder
N-J554	0611-6720	554	center conductor, without solder

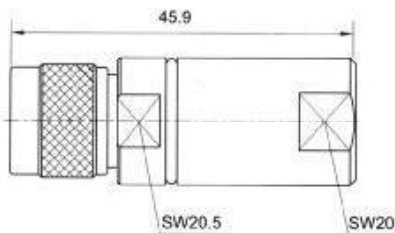

Type	part number	suitable cable	Note
N-J534B	0611-6714	534	center conductor, without solder

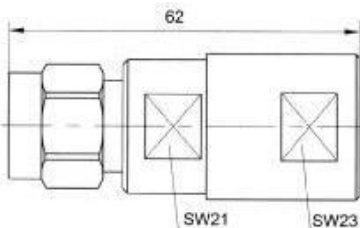

Type	part number	suitable cable	Note
N-J534E	0611-6717	534	center conductor, without solder

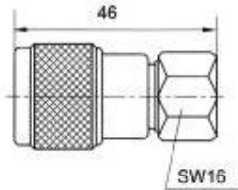

Type	part number	suitable cable	Note
N-J608G	0614-6502	608	center conductor solder

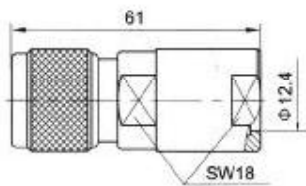

Type	part number	suitable cable	Note
N-J609G	0614-6503	609	center conductor without solder

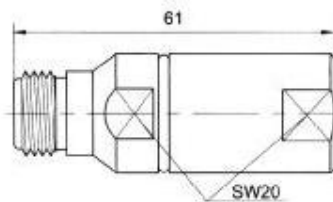

Type	part number	suitable cable	Note
N-K534	0621-6702	534	center conductor without solder

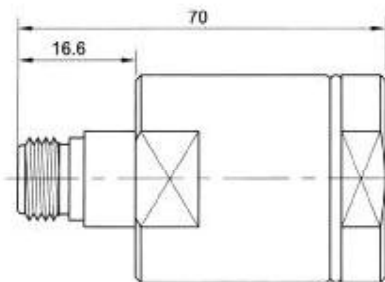

Type	part number	suitable cable	Note
N-K554	0621-6705	7/8" corrugated(ring) copper foam cable	center conductor without solder
N-K554A	0621-6706	7/8" corrugated(ring) copper foam cable	center conductor without solder

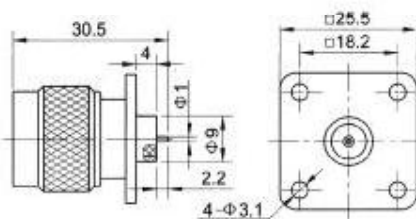

Type	part number	suitable cable	Note
N-JFD1	0611-0002		

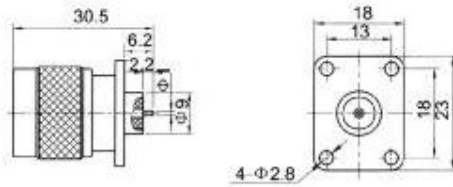

Type	part number	Note
N-JFD1A	0611-0003	

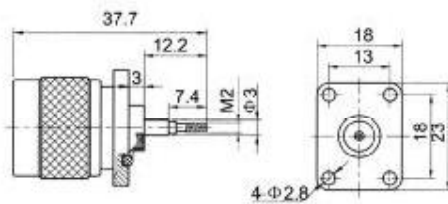

Type	part number	Note
N-JFD9	0621-0056	

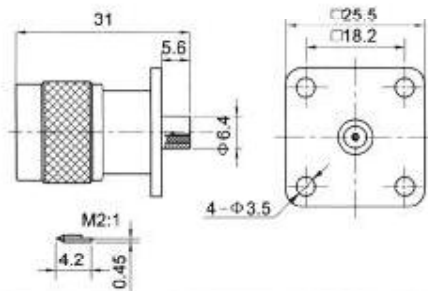

Type	part number	Note
N-JFD10	0611-0012	

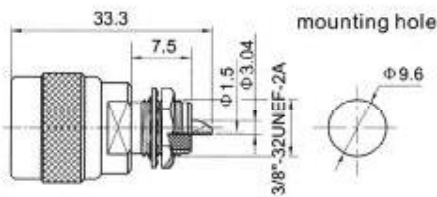

Type	part number	Note
N-JYD	0611-2801	

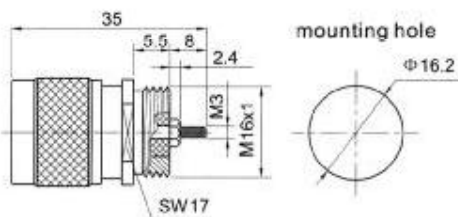

Type	part number	Note
N-JYD1	0611-2802	

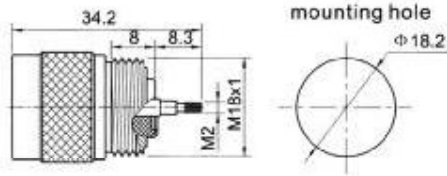

Type	part number	Note
N-JYD2	0611-2803	

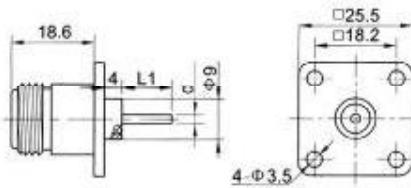

Type	part number	L1	d	Note
N-KFD	0621-0001	22	Φ1	
N-KFD6	0621-0012	11	Φ2	
N-KFD6A	0621-0013	22	Φ1	body silver plated
N-KFD6D	0621-0012	11	Φ1	
N-KFD13	0621-0026	22	Φ1	

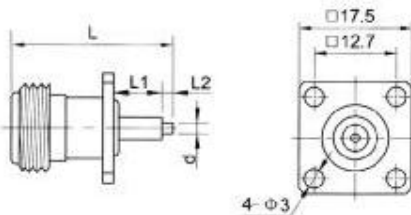

Type	part number	L	L1	L2	d	Note
N-KFD2	0621-0005	23.5	8.8	2	Φ1.3	seal rings
N-KFD3	0621-0006	41.5	18.8	4	Φ1.3	seal rings
N-KFD11	0621-0024	36.5	15	3	Φ1.2	
N-KFD12	0621-0025	29.3	9.5	1.3	Φ1.3	
N-KFD19	0621-0032	45.7	25	2	Φ1.3	seal rings
N-KFD20	0621-0033	29.8	9.3	1.7	Φ1.3	seal rings
N-KFD21	0621-0034	78.7	58	2	Φ1.5	seal rings
N-KFD22	0621-0035	30.1	5.1	6.3	Φ1.3	

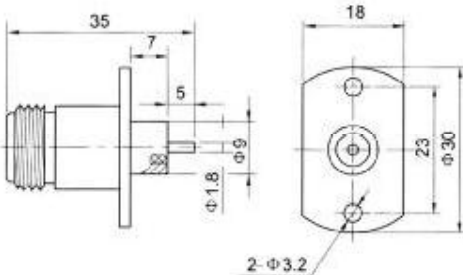

Type	part number	Note
N-KFD4	0621-0007	

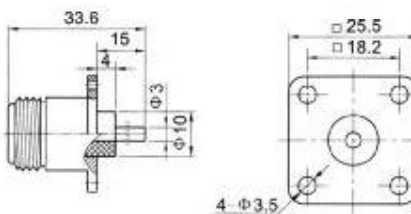

Type	part number	Note
N-KFD6C	0621-0015	

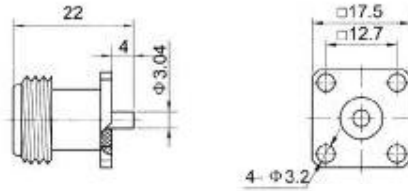

Type	part number	Note
N-KFD18	0621-0031	

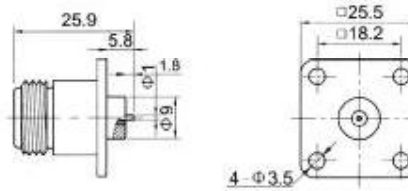

Type	part number	Note
N-KFD38	0621-0049	

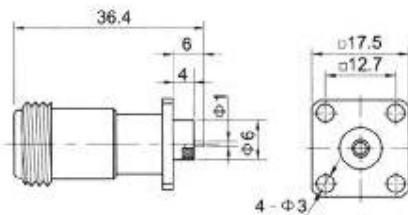

Type	part number	Note
N-KFD39	0621-0062	

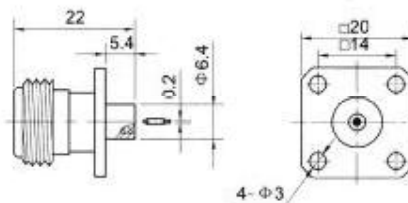

Type	part number	Note
N-KFD1	0621-0002	male pin on back end

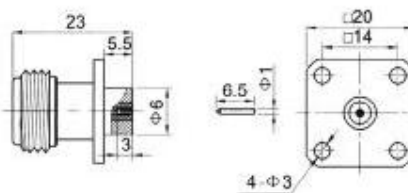

Type	part number	Note
N-KFD17	0621-0030	male pin on back end

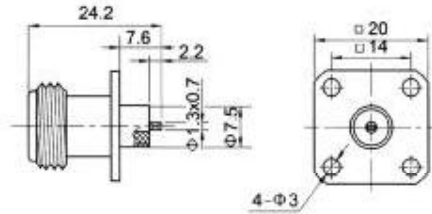

Type	part number	Note
N-KFD10	0621-0022	

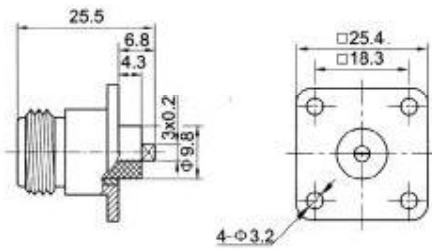

Type	part number	Note
N-KFD31	0621-0044	

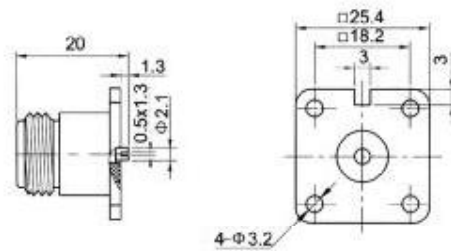

Type	part number	Note
N-KFD15	0621-0028	

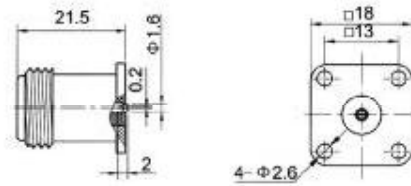

Type	part number	Note
N-KFD45	0621-0056	



Type	part number	Note
N-KFD48	0621-0059	

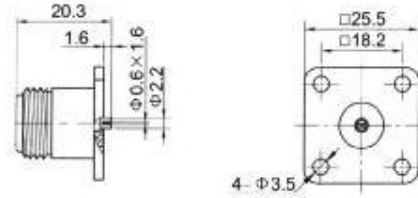

Type	part number	Note
N-KFD52	0621-0063	

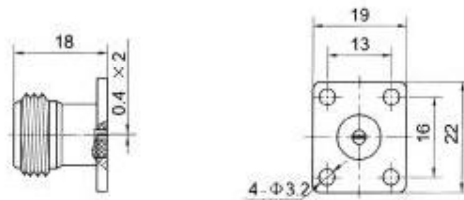

Type	part number	Note
N-KF11	0621-1906	

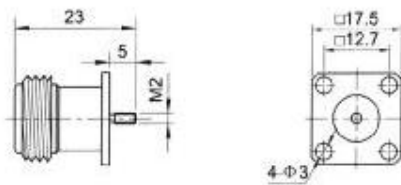

Type	part number	Note
N-KFD5	0621-0009	

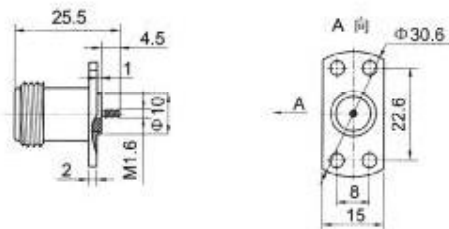

Type	part number	Note
N-KFD29	0621-0042	

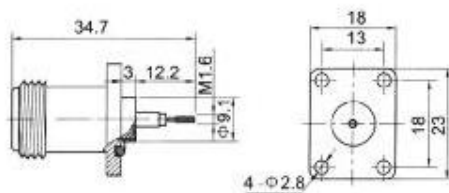

Type	part number	Note
N-KFD30	0621-0043	

# N SERIES

# CERNEXWAVE

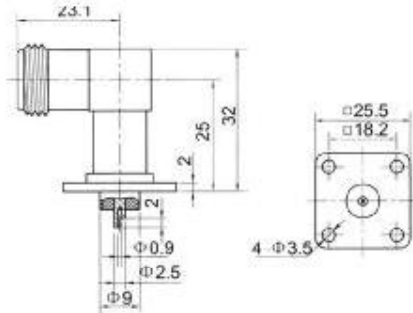

Type	part number	Note
N-KWFD2	0641-1802	

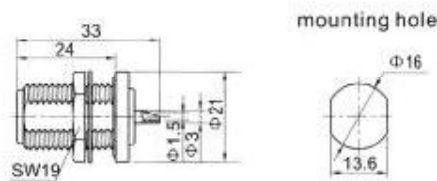

Type	part number	Note
N-50KY	0621-2901	

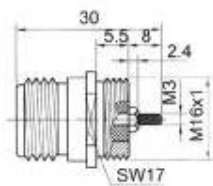

Type	part number	Note
N-KYD5	0621-2806	

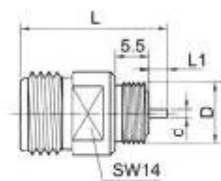

Type	part number	L	L1	d	D	Note
N-KYD6	0621-2807	28	4	1.5	M12X1	
N-KYD12	0621-2813	23.9	2	1.3	M8X1	
N-KYD13	0621-2814	27	3	M2	M12X1	

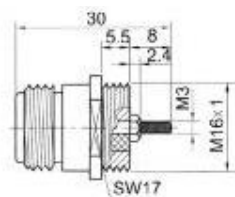

Type	part number	Note
N-KYD1	0621-2801	





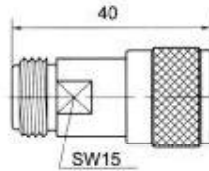

Type	part number	Note
N-50JK	0601-6905	

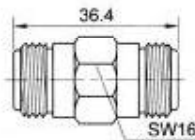

Type	part number	Note
N-KK	0601-6913	

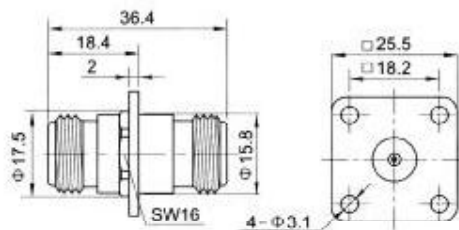

Type	part number	Note
N-50KFK	0601-1901	

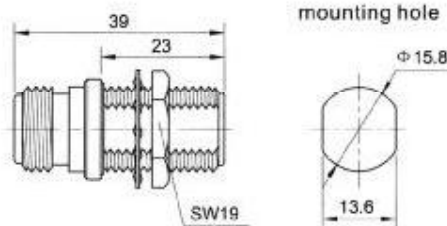

Type	part number	Note
N-KYK3	0601-2907	

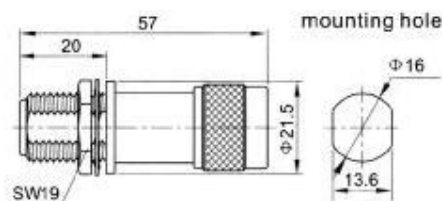

Type	part number	Note
N-KYJA	0601-2902	

# N SERIES

# CERNEXWAVE

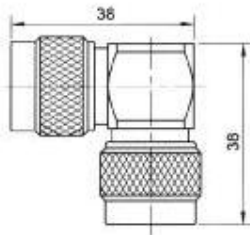

Type	part number	Note
------	-------------	------

N-JWJ	0601-6922	
-------	-----------	--

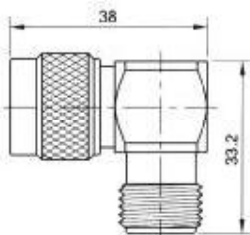

Type	part number	Note
------	-------------	------

N-JWK	0601-6923	
-------	-----------	--

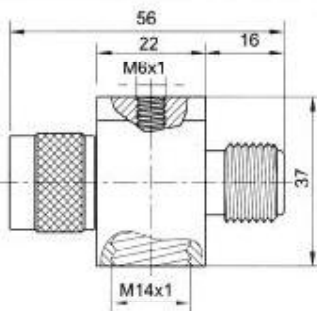

Type	part number	Note
------	-------------	------

N-JKB	0601-0024	center conductor configuration
-------	-----------	--------------------------------

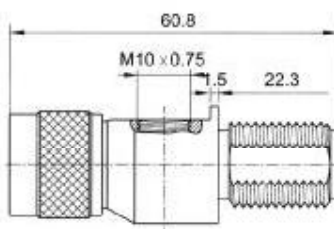

Type	part number	Note
------	-------------	------

N-JKE	0601-0911	
-------	-----------	--

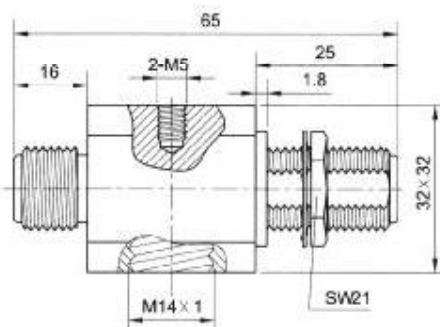

Type	part number	Note
------	-------------	------

N-KKD	0601-6919	
-------	-----------	--