

**SERIES 2.92mm
RF COAXIAL CONNECTORS**

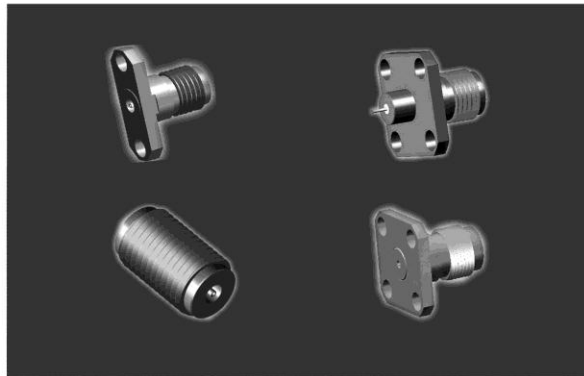

2.92mm connectors are 50Ω precision connectors. They have been designed with excellent characteristics over the full frequency range up to 40GHz. 2.92mm connectors are mechanically compatible with 3.5mm, SMA connectors.

Key performance

Characteristic Impedance : 50 Ω
 Frequency range : DC-40GHz
 Contact resistance :
 Center Contact ≤ 3.0mΩ
 Housing ≤ 2.0mΩ
 Insulation resistance : ≥ 3000MΩ
 Insulator voltage withstanding : 750V
 VSWR :
 DC-40GHz.... 1.15:1 (max)

Connector durability : 500 cycles

Interfaces: PER MIL-STD-348A

Material

Housing: Stainless Steel SU303 Polished/Passivated
 Center Contact: Beryllium Copper
 Gold plated (MIL-G-45204)
 Insulators: PEI or PEI&PTFE

Interface Dimensions

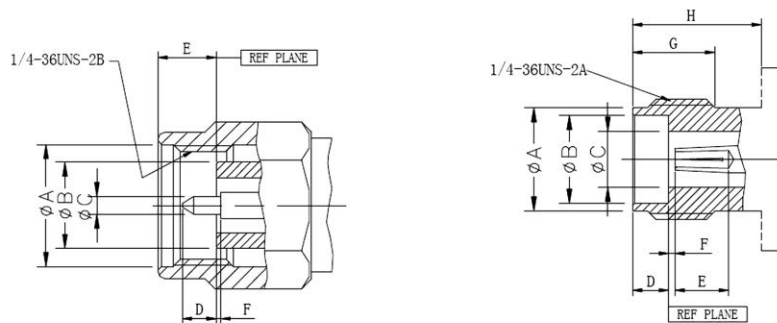

2.92MM SERIES

CERNEXWAVE

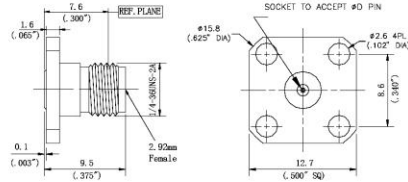

| Part number | ΦD |
|-----------------|-------------|
| 2.92-KFD0S09F01 | 0.23/0.009" |
| 2.92-KFD0S12F01 | 0.30/0.012" |
| 2.92-KFD0S15F01 | 0.38/0.015" |
| 2.92-KFD0S20F01 | 0.51/0.020" |

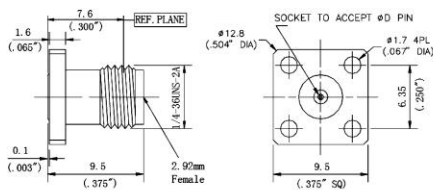

| Part number | ΦD |
|-----------------|-------------|
| 2.92-KFD0S09F02 | 0.23/0.009" |
| 2.92-KFD0S12F02 | 0.30/0.012" |
| 2.92-KFD0S15F02 | 0.38/0.015" |
| 2.92-KFD0S20F02 | 0.51/0.020" |

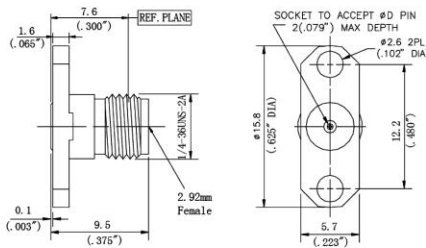

| Part number | ΦD |
|-----------------|-------------|
| 2.92-KFD0S09F04 | 0.23/0.009" |
| 2.92-KFD0S12F04 | 0.30/0.012" |
| 2.92-KFD0S15F04 | 0.38/0.015" |
| 2.92-KFD0S20F04 | 0.51/0.020" |

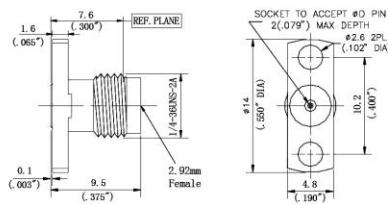

| Part number | ΦD |
|-----------------|-------------|
| 2.92-KFD0S09F05 | 0.23/0.009" |
| 2.92-KFD0S12F05 | 0.30/0.012" |
| 2.92-KFD0S15F05 | 0.38/0.015" |
| 2.92-KFD0S20F05 | 0.51/0.020" |

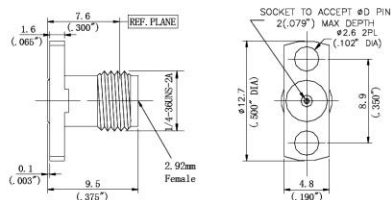

| Part number | ΦD |
|-----------------|-------------|
| 2.92-KFD0S09F06 | 0.23/0.009" |
| 2.92-KFD0S12F06 | 0.30/0.012" |
| 2.92-KFD0S15F06 | 0.38/0.015" |
| 2.92-KFD0S20F06 | 0.51/0.020" |

2.92MM SERIES

CERNEXWAVE

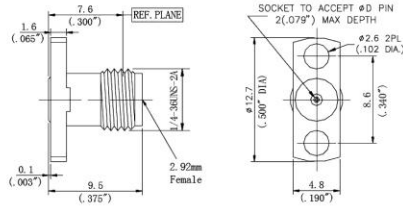

| Part number | ΦD |
|-----------------|-------------|
| 2.92-KFD0S09F07 | 0.23/0.009" |
| 2.92-KFD0S12F07 | 0.30/0.012" |
| 2.92-KFD0S15F07 | 0.38/0.015" |
| 2.92-KFD0S20F07 | 0.51/0.020" |

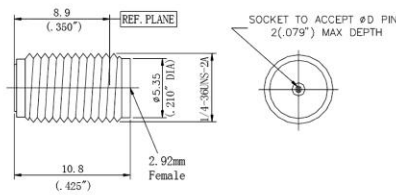

| Part number | ΦD |
|-----------------|-------------|
| 2.92-KYB0S09Y02 | 0.23/0.009" |
| 2.92-KYB0S12Y02 | 0.30/0.012" |
| 2.92-KYB0S15Y02 | 0.38/0.015" |
| 2.92-KYB0S20Y02 | 0.51/0.020" |

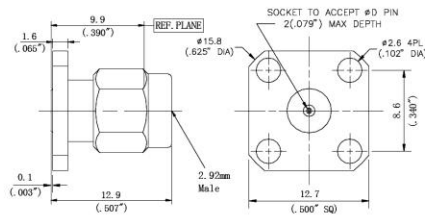

| Part number | ΦD |
|-----------------|-------------|
| 2.92-JFD1S09F01 | 0.23/0.009" |
| 2.92-JFD1S12F01 | 0.30/0.012" |
| 2.92-JFD1S15F01 | 0.38/0.015" |
| 2.92-JFD1S20F01 | 0.51/0.020" |

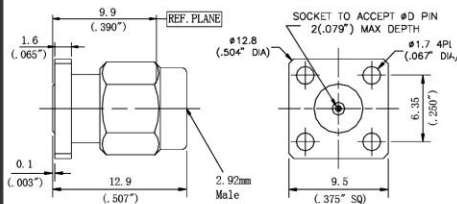

| Part number | ΦD |
|-----------------|-------------|
| 2.92-JFD1S09F02 | 0.23/0.009" |
| 2.92-JFD1S12F02 | 0.30/0.012" |
| 2.92-JFD1S15F02 | 0.38/0.015" |
| 2.92-JFD1S20F02 | 0.51/0.020" |

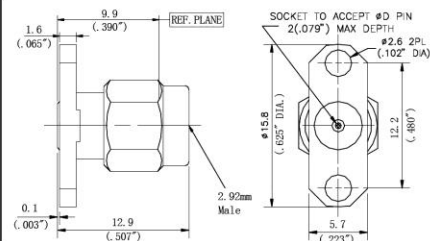

| Part number | ΦD |
|-----------------|-------------|
| 2.92-JFD1S09F04 | 0.23/0.009" |
| 2.92-JFD1S12F04 | 0.30/0.012" |
| 2.92-JFD1S15F04 | 0.38/0.015" |
| 2.92-JFD1S20F04 | 0.51/0.020" |

2.92MM SERIES

CERNEXWAVE

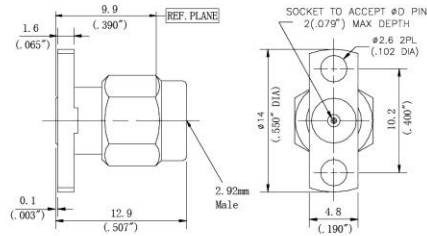

| Part number | ΦD |
|-----------------|-------------|
| 2.92-JFD1S09F05 | 0.23/0.009" |
| 2.92-JFD1S12F05 | 0.30/0.012" |
| 2.92-JFD1S15F05 | 0.38/0.015" |
| 2.92-JFD1S20F05 | 0.51/0.020" |

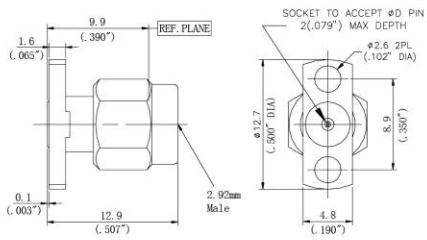

| Part number | ΦD |
|-----------------|-------------|
| 2.92-JFD1S09F06 | 0.23/0.009" |
| 2.92-JFD1S12F06 | 0.30/0.012" |
| 2.92-JFD1S15F06 | 0.38/0.015" |
| 2.92-JFD1S20F06 | 0.51/0.020" |

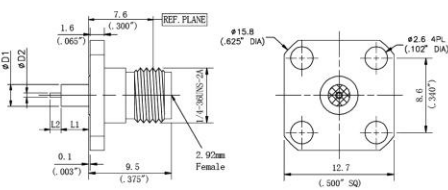

| Part number | D1 | D2 | L1 | L2 |
|------------------|----|-----|------|------|
| 2.92-KFDM0403F01 | 4 | 0.3 | 1.4 | 1.5 |
| 2.92-KFDM0503F01 | 4 | 0.3 | 3 | 1.5 |
| 2.92-KFDM1105F01 | 4 | 0.6 | 10.1 | 1.27 |

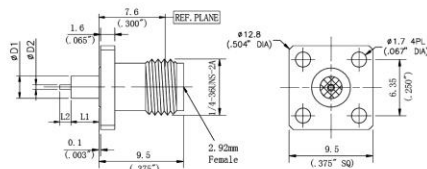

| Part number | D1 | D2 | L1 | L2 |
|------------------|----|-----|------|------|
| 2.92-KFDM0403F02 | 4 | 0.3 | 1.4 | 1.5 |
| 2.92-KFDM0503F02 | 4 | 0.3 | 3 | 1.5 |
| 2.92-KFDM1105F02 | 4 | 0.6 | 10.1 | 1.27 |

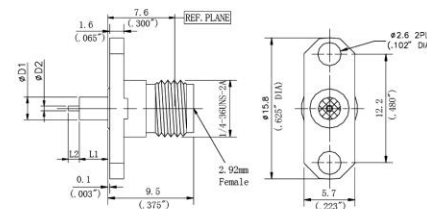

| Part number | D1 | D2 | L1 | L2 |
|------------------|----|-----|------|------|
| 2.92-KFDM0403F04 | 4 | 0.3 | 1.4 | 1.5 |
| 2.92-KFDM0503F04 | 4 | 0.3 | 3 | 1.5 |
| 2.92-KFDM1105F04 | 4 | 0.6 | 10.1 | 1.27 |

2.92MM SERIES

CERNEXWAVE

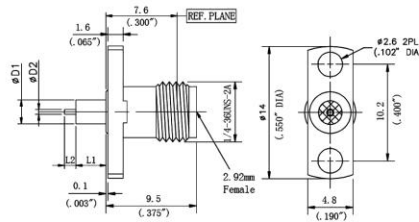

| Part number | D1 | D2 | L1 | L2 |
|-------------------|----|-----|------|------|
| 2.92-KFD0M0403F05 | 4 | 0.3 | 1.4 | 1.5 |
| 2.92-KFD0M0503F05 | 4 | 0.3 | 3 | 1.5 |
| 2.92-KFD0M1105F05 | 4 | 0.6 | 10.1 | 1.27 |

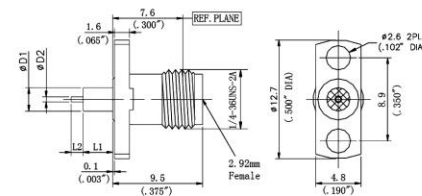

| Part number | D1 | D2 | L1 | L2 |
|-------------------|----|-----|------|------|
| 2.92-KFD0M0403F06 | 4 | 0.3 | 1.4 | 1.5 |
| 2.92-KFD0M0503F06 | 4 | 0.3 | 3 | 1.5 |
| 2.92-KFD0M1105F06 | 4 | 0.6 | 10.1 | 1.27 |

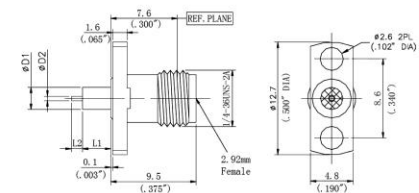

| Part number | D1 | D2 | L1 | L2 |
|-------------------|----|-----|------|------|
| 2.92-KFD0M0403F07 | 4 | 0.3 | 1.4 | 1.5 |
| 2.92-KFD0M0503F07 | 4 | 0.3 | 3 | 1.5 |
| 2.92-KFD0M1105F07 | 4 | 0.6 | 10.1 | 1.27 |

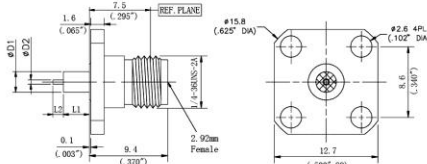

| Part number | D1 | D2 | L1 | L2 |
|-------------------|------|-----|-----|-----|
| 2.92-KFD0P0403F01 | 1.67 | 0.3 | 1.4 | 1.5 |
| 2.92-KFD0P0503F01 | 1.67 | 0.3 | 3 | 1.5 |

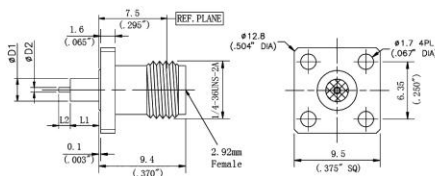

| Part number | D1 | D2 | L1 | L2 |
|-------------------|------|-----|-----|-----|
| 2.92-KFD0P0403F02 | 1.67 | 0.3 | 1.4 | 1.5 |
| 2.92-KFD0P0503F02 | 1.67 | 0.3 | 3 | 1.5 |

2.92MM SERIES

CERNEXWAVE

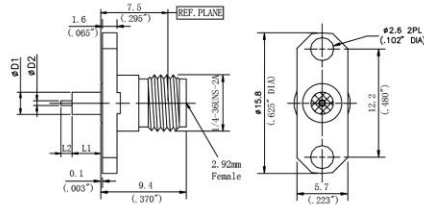

| Part number | D1 | D2 | L1 | L2 |
|-------------------|------|-----|-----|-----|
| 2.92-KFD0P0403F04 | 1.67 | 0.3 | 1.4 | 1.5 |
| 2.92-KFD0P0503F04 | 1.67 | 0.3 | 3 | 1.5 |

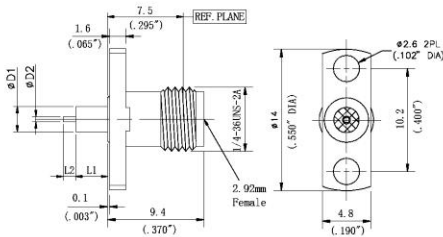

| Part number | D1 | D2 | L1 | L2 |
|-------------------|------|-----|-----|-----|
| 2.92-KFD0P0403F05 | 1.67 | 0.3 | 1.4 | 1.5 |
| 2.92-KFD0P0503F05 | 1.67 | 0.3 | 3 | 1.5 |

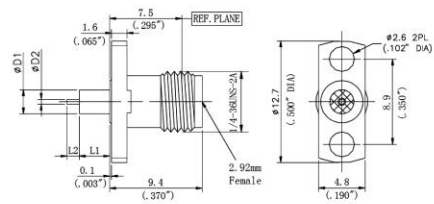

| Part number | D1 | D2 | L1 | L2 |
|-------------------|------|-----|-----|-----|
| 2.92-KFD0P0403F06 | 1.67 | 0.3 | 1.4 | 1.5 |
| 2.92-KFD0P0503F06 | 1.67 | 0.3 | 3 | 1.5 |

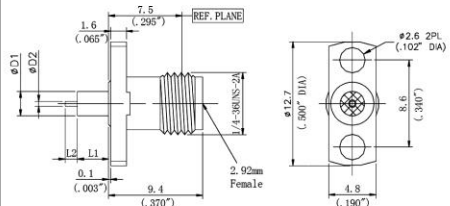

| Part number | D1 | D2 | L1 | L2 |
|-------------------|------|-----|-----|-----|
| 2.92-KFD0P0403F07 | 1.67 | 0.3 | 1.4 | 1.5 |
| 2.92-KFD0P0503F07 | 1.67 | 0.3 | 3 | 1.5 |

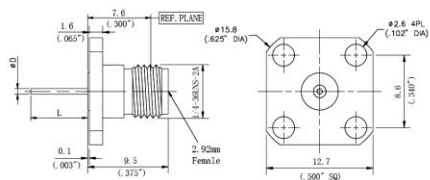

| Part number | D | L |
|----------------------|-------------|--------------|
| 2.92-KFD0D25F01-430 | 0.64/0.025" | 10.92/0.430" |
| 2.92-KFD0D25F01-269 | 0.64/0.025" | 6.84/0.269" |
| 2.92-KFD0D12F01-276 | 0.30/0.12" | 7/0.276" |
| 2.92-KFD0D30F01-1181 | 0.75/0.030" | 30/1.181" |

2.92MM SERIES

CERNEXWAVE

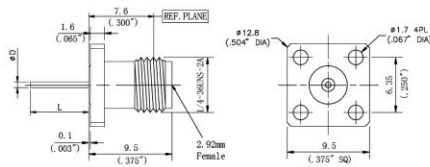

| Part number | D | L |
|----------------------|-------------|--------------|
| 2.92-KFD0D25F02-430 | 0.64/0.025" | 10.92/0.430" |
| 2.92-KFD0D25F02-269 | 0.64/0.025" | 6.84/0.269" |
| 2.92-KFD0D12F02-276 | 0.30/0.12" | 7/0.276" |
| 2.92-KFD0D30F02-1181 | 0.75/0.030" | 30/1.181" |

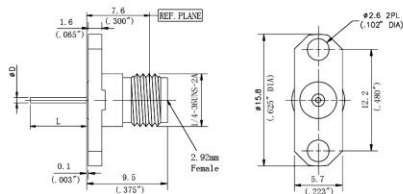

| Part number | D | L |
|----------------------|-------------|--------------|
| 2.92-KFD0D25F04-430 | 0.64/0.025" | 10.92/0.430" |
| 2.92-KFD0D25F04-269 | 0.64/0.025" | 6.84/0.269" |
| 2.92-KFD0D12F04-276 | 0.30/0.12" | 7/0.276" |
| 2.92-KFD0D30F04-1181 | 0.75/0.030" | 30/1.181" |

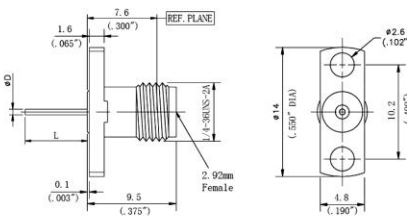

| Part number | D | L |
|----------------------|-------------|--------------|
| 2.92-KFD0D25F05-430 | 0.64/0.025" | 10.92/0.430" |
| 2.92-KFD0D25F05-269 | 0.64/0.025" | 6.84/0.269" |
| 2.92-KFD0D12F05-276 | 0.30/0.12" | 7/0.276" |
| 2.92-KFD0D30F05-1181 | 0.75/0.030" | 30/1.181" |

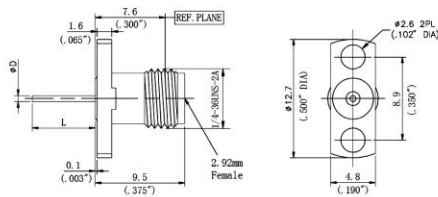

| Part number | D | L |
|----------------------|-------------|--------------|
| 2.92-KFD0D25F06-430 | 0.64/0.025" | 10.92/0.430" |
| 2.92-KFD0D25F06-269 | 0.64/0.025" | 6.84/0.269" |
| 2.92-KFD0D12F06-276 | 0.30/0.12" | 7/0.276" |
| 2.92-KFD0D30F06-1181 | 0.75/0.030" | 30/1.181" |

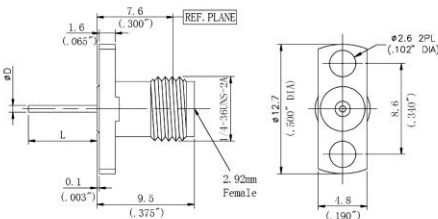

| Part number | D | L |
|----------------------|-------------|--------------|
| 2.92-KFD0D25F07-430 | 0.64/0.025" | 10.92/0.430" |
| 2.92-KFD0D25F07-269 | 0.64/0.025" | 6.84/0.269" |
| 2.92-KFD0D12F07-276 | 0.30/0.12" | 7/0.276" |
| 2.92-KFD0D30F07-1181 | 0.75/0.030" | 30/1.181" |

2.92MM SERIES

CERNEXWAVE

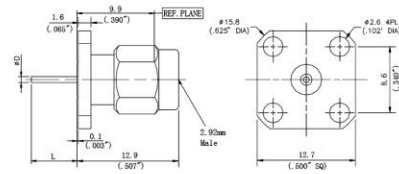

| Part number | D | L |
|---------------------|-------------|--------------|
| 2.92-JFD1D25F01-430 | 0.64/0.025" | 10.92/0.430" |
| 2.92-JFD1D25F01-269 | 0.64/0.025" | 6.84/0.269" |

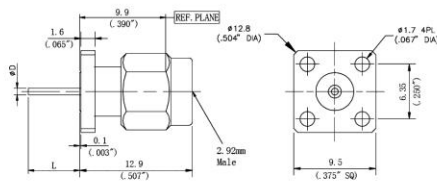

| Part number | D | L |
|---------------------|-------------|--------------|
| 2.92-JFD1D25F02-430 | 0.64/0.025" | 10.92/0.430" |
| 2.92-JFD1D25F02-269 | 0.64/0.025" | 6.84/0.269" |

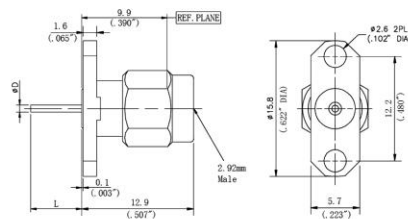

| Part number | D | L |
|---------------------|-------------|--------------|
| 2.92-JFD1D25F04-430 | 0.64/0.025" | 10.92/0.430" |
| 2.92-JFD1D25F04-269 | 0.64/0.025" | 6.84/0.269" |

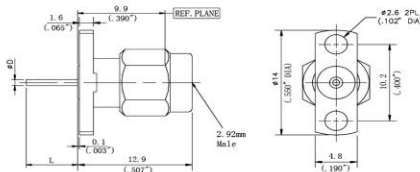
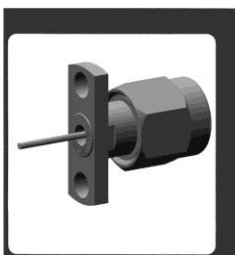

| Part number | D | L |
|---------------------|-------------|--------------|
| 2.92-JFD1D25F05-430 | 0.64/0.025" | 10.92/0.430" |
| 2.92-JFD1D25F05-269 | 0.64/0.025" | 6.84/0.269" |

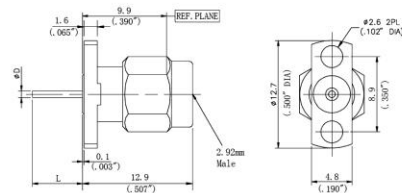

| Part number | D | L |
|---------------------|-------------|--------------|
| 2.92-JFD1D25F06-430 | 0.64/0.025" | 10.92/0.430" |
| 2.92-JFD1D25F06-269 | 0.64/0.025" | 6.84/0.269" |

2.92MM SERIES

CERNEXWAVE

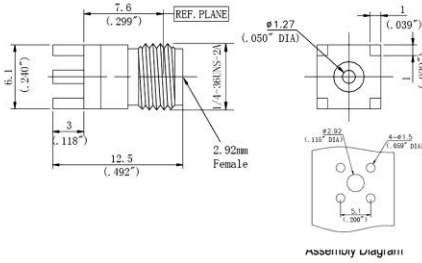

Assembly Diagram

Part number

2.92-KHD0B50H01-118

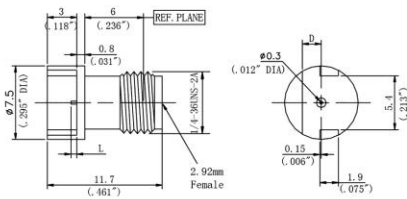

Part number

D

L

PCB Board Thickness

| | | | |
|---------------------|-------------|------------|-------------|
| 2.92-KHB0B12E01-023 | 1.93/0.076" | 0.6/0.023" | 1.78/0.070" |
| 2.92-KHB0B12E02-023 | 0.76/0.030" | 0.6/0.023" | 0.61/0.024" |
| 2.92-KHB0B12E03-023 | 1.02/0.040" | 0.6/0.023" | 0.87/0.034" |

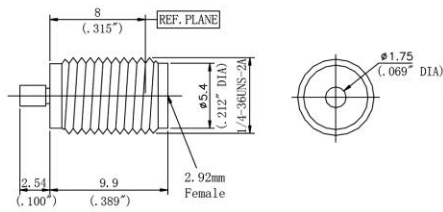

Part number

2.92-KYB0L69Y01-100